

## Versatile Configurations for Inline Duct Fans Direct-Mounted Exhaust and Duct-Integrated Models

### Our Product Introduction

for more products please visit us on [zd-fan.com](http://zd-fan.com)

#### Basic Information

- Place of Origin: China Foshan
- Brand Name: Available for ODM
- Certification: CE
- Model Number: BPT10-12
- Minimum Order Quantity: 1
- Price: Contact Us
- Packaging Details: Carton packaging 1 units per carton
- Delivery Time: 3-8 work days
- Payment Terms: T/T
- Supply Ability: 5000



#### Product Specification

- Type: Axial Flow Fan
- Applicable Industries: Hotels, Building Material Shops, Home Use, Retail, Construction Works
- Mounting: Ceiling Mounting
- Motor: Capacitor Copper Wire Motor
- Noise: MAX 45 DB
- Voltage (V): 220V
- Air Flow: 120-500 M³/h



#### More Images



## Product Description

### Product Overview

Our high - performance ventilation units are expertly designed to tackle the challenge of excessive humidity. They are specifically engineered to extract moisture - laden air from areas prone to high humidity, such as bathrooms, laundry rooms, restrooms, and indoor swimming pools.

These ventilation systems feature scalable airflow capacities, which means they can be easily adjusted to fit spaces of various sizes. Whether it's a small residential washroom or a large - scale commercial pool enclosure, our units can provide efficient ventilation.

Available in a wide range of configurations, including direct - mounted exhaust fans and duct - integrated in - line models, all of our products share a common goal: to redirect excess humidity outside through ductwork, thereby maintaining a balanced and healthy indoor air quality.

### Key Advantages

#### Durable Build

The ventilation units are encased in a full - metal housing. This not only ensures long - lasting durability but also makes it easier to integrate the units with air outlets.

#### Reliable Operation

Powered by a capacitor - driven motor, these units offer reliable performance over an extended period. With minimal maintenance requirements, the motor guarantees a long operational lifespan.

#### Safety First

Each unit is equipped with a built - in thermal overload protector. This safety feature prevents the unit from overheating, significantly enhancing user safety.

#### Adaptable Design

Our ventilation systems are designed for maximum adaptability. They are compatible with ceiling - mounted installations and can be easily connected to ducts or pipes. This design simplifies both the installation and maintenance processes.

#### User - Friendly Features

To make cleaning and servicing hassle - free, the units come with pre - adjusted mounting brackets and tool - free access panels.

## General assembly Drawing

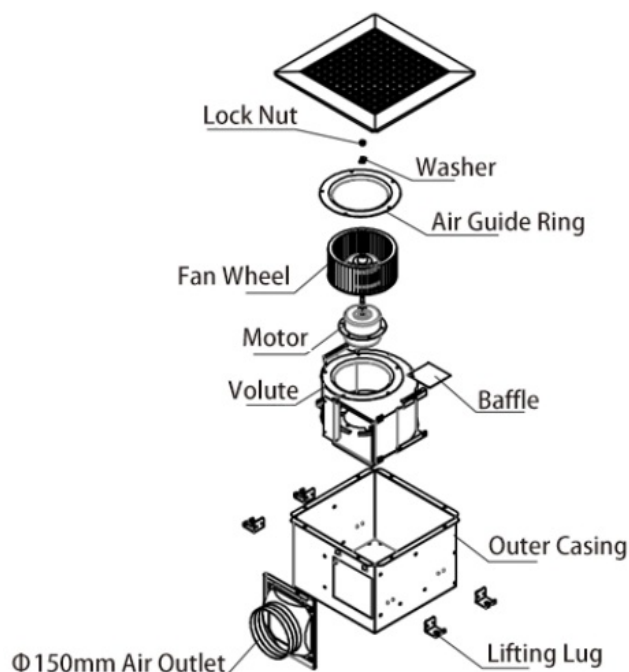

## Product Installation Method

### Step 1: Frame Construction

Begin by constructing a sturdy ceiling - mounted frame using corrosion - resistant materials. This step is crucial for ensuring the structural stability of the ventilation unit.

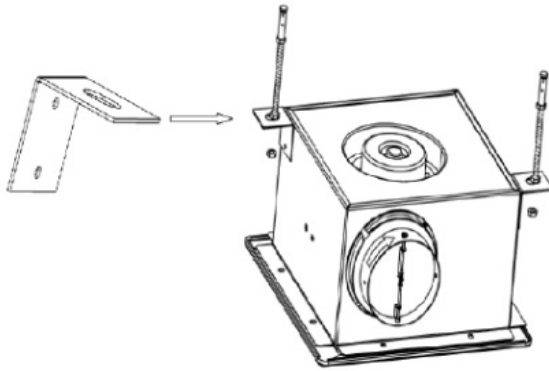

### Step 2: Fan Attachment

Once the frame is ready, attach the fan enclosure or housing unit to it. Use vibration - dampening fasteners to secure the unit, which helps reduce noise and vibrations during operation.

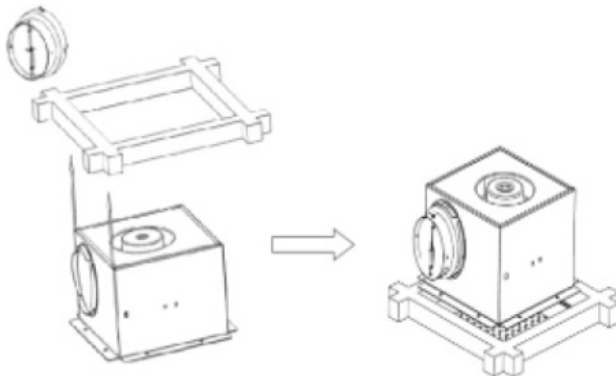

### Step 3: Duct Connection

Align the duct connector with the directional arrow (which indicates the airflow path). Then, use a twist - to - lock system to attach the duct connector to the cabinet's exhaust port. This ensures an airtight seal, preventing any leakage of humid air.

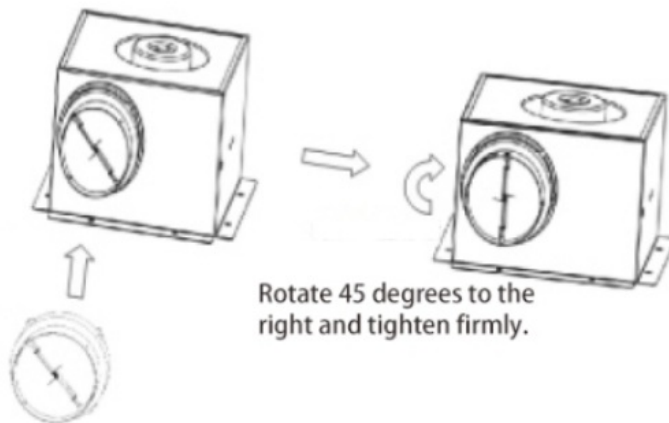

Rotate 45 degrees to the right and tighten firmly.

Fasten the air duct interface to the air inlet and outlet.

## Product Performance Curve

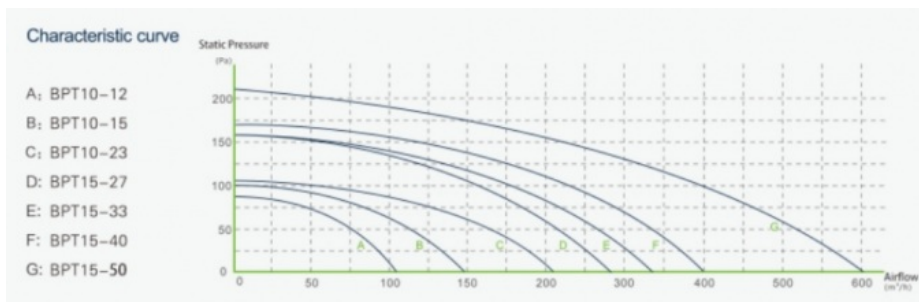

### Product Performance Specifications

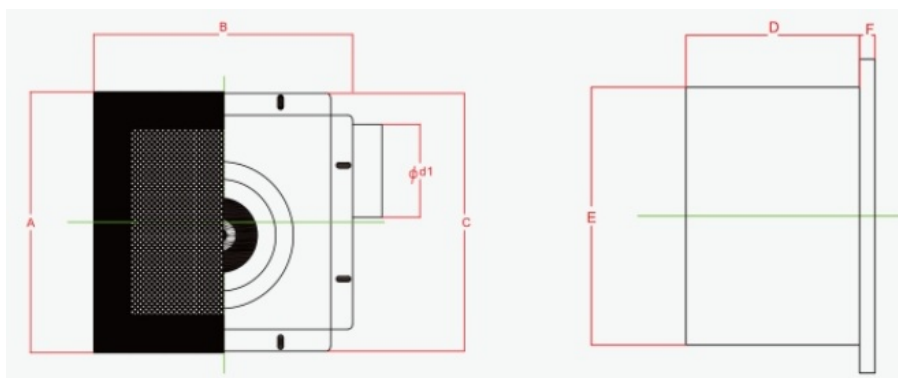

Model Num	A	B	C	D	E	F	Cutout Dimensions
BPT10-12	280	280	277	155	230	14	230*240
BPT10-15	280	280	277	155	230	14	230*240
BPT10-21	280	280	277	155	230	14	230*240
BPT15-27	380	380	341	224	306	14	306*306
BPT15-33	380	380	341	224	306	14	306*306
BPT15-40	380	380	341	224	306	14	306*306
BPT15-60	380	380	341	224	306	14	306*306

 **ZhongDian** Guangdong Zhongdian Jiajin Environmental Technology Co., Ltd.

 0085246403891

 sales001@zd-fan.com

 zd-fan.com

Xizi Industrial Zone, Lishui Town, Nanhai District, Foshan City, Guangdong Province, China