

## Seamlessly Integrate Inline Duct Fans into Your Space for Fresher Air

### Our Product Introduction

#### Basic Information

- Place of Origin: China Foshan
- Brand Name: Available for ODM
- Certification: CE
- Model Number: BPT10-12
- Minimum Order Quantity: 1
- Price: Contact Us
- Packaging Details: Carton packaging 1 units per carton
- Delivery Time: 3-8 work days
- Payment Terms: T/T
- Supply Ability: 5000



#### Product Specification

- Function: Air Flow Circulation
- Mounting: Ceiling
- Voltage: 220V
- Power: 24-100W
- Air Volume: 120-600 M³/h
- Core Components: Motor, Engine
- Noise: 32-58 DB
- Static Pressure(Pa): 80-220 Pa
- Motor: 100% Copper Coil
- Duct Size: 100 Mm / 150 Mm
- Applications: Hotel / School / Residence / Office / Bathroom
- Highlight: 220v inline duct fans, 220v inline extractor fan



#### More Images



## Product Description

### Product Overview

Modern ventilation systems now prioritize metal ceiling fans as integral components for indoor climate management. These advanced units optimize air quality through effective humidity regulation, odor neutralization, and particulate reduction, creating healthier environments across diverse applications. Suitable for commercial complexes, hospitality venues, dining establishments, private residences, and corporate offices, they combine utility with aesthetic versatility.

The core mechanism features a high-performance motor engineered with precision-grade bearings to minimize operational noise and maximize durability. Housed within a corrosion-resistant metallic casing and paired with a reinforced alloy impeller, the system guarantees consistent airflow efficiency. Its aerodynamically optimized blade design resists deformation over prolonged use, ensuring sustained performance and structural integrity.

### General assembly Drawing

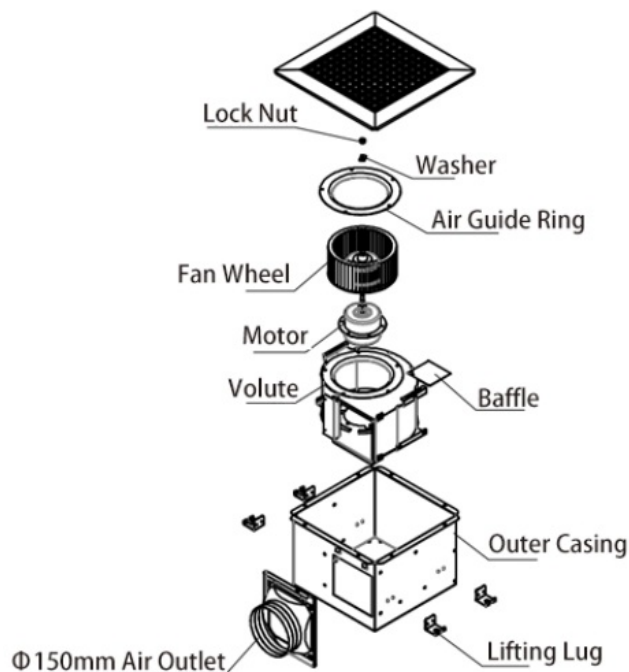

### Product Installation Method

#### Frame Preparation

Construct a robust rectangular wooden support structure anchored securely to the ceiling joists or load-bearing beams.

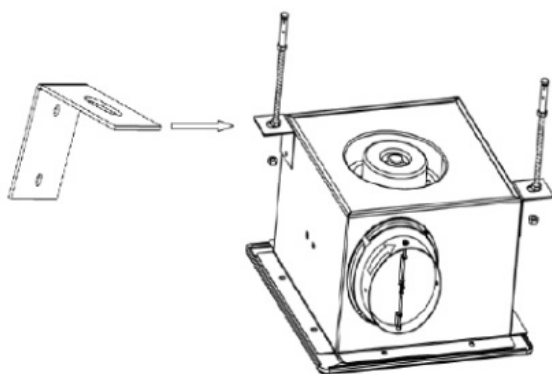

#### Unit Mounting

Fix the fan housing assembly to the pre-installed wooden framework using corrosion-resistant fasteners, ensuring full contact with the mounting surface.

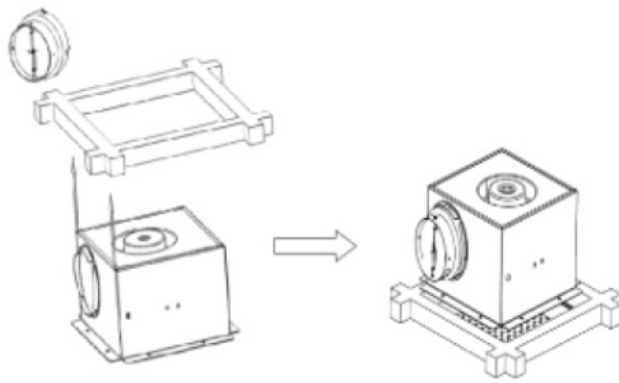

### Duct Integration

Align the ventilation duct adapter with the airflow directional indicator, then engage the twist-lock mechanism to seal it onto the cabinet's exhaust port. Verify airtight connectivity through pressure testing.

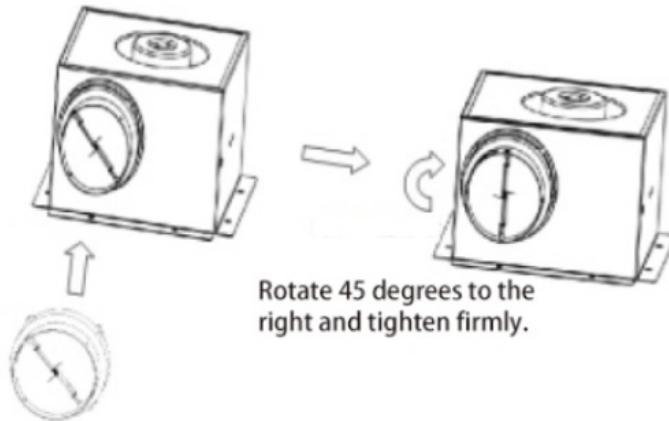

Rotate 45 degrees to the right and tighten firmly.

Fasten the air duct interface to the air inlet and outlet.

## Product Performance Curve

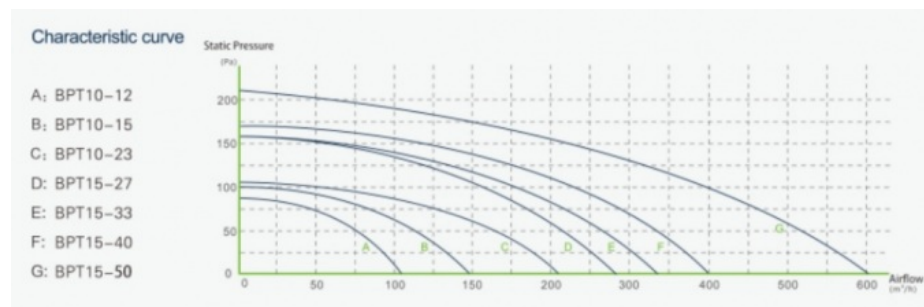

### Product Performance Specifications

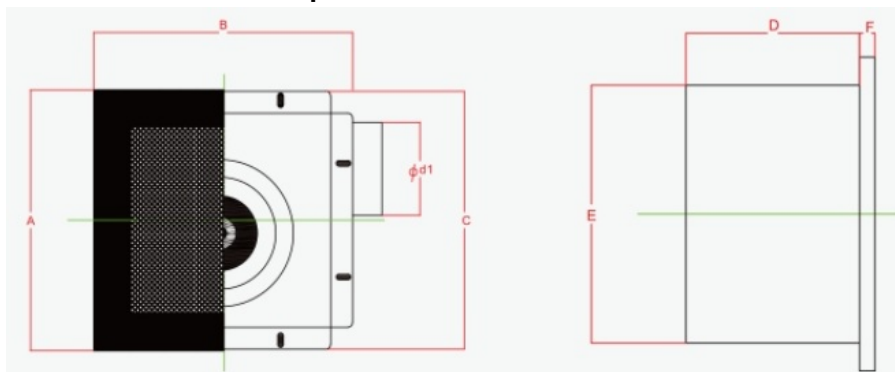

Model Num	A	B	C	D	E	F	Cutout Dimensions
BPT10-12	280	280	277	155	230	14	230*240
BPT10-15	280	280	277	155	230	14	230*240
BPT10-21	280	280	277	155	230	14	230*240

BPT15-27	380	380	341	224	306	14	306*306
BPT15-33	380	380	341	224	306	14	306*306
BPT15-40	380	380	341	224	306	14	306*306
BPT15-60	380	380	341	224	306	14	306*306

 **ZhongDian** **Guangdong Zhongdian Jiajin Environmental Technology Co., Ltd.**



0085246403891



sales001@zd-fan.com



zd-fan.com

Xizi Industrial Zone, Lishui Town, Nanhai District, Foshan City, Guangdong Province, China