

## Seamless Integration of Fresh Air Intake Inline Duct Fans for Improved Air in Commercial Environments

### Our Product Introduction

for more products please visit us on [zd-fan.com](http://zd-fan.com)

#### Basic Information

- Place of Origin: China Foshan
- Brand Name: Available for ODM
- Certification: CE
- Model Number: BPT10-12
- Minimum Order Quantity: 1
- Price: Contact Us
- Packaging Details: Carton packaging 1 units per carton
- Delivery Time: 3-8 work days
- Payment Terms: T/T
- Supply Ability: 5000



#### Product Specification

- Function: Ceiling Air Flow Ventilator System
- Mounting: Ceiling
- Voltage: 220V
- Power: 24-100W
- Air Volume: 120-600 M³/h
- Core Components: Motor, Engine
- Noise: 32-58 DB
- Static Pressure(Pa): 80-220 Pa
- Motor: 100% Copper Coil
- Duct Size: 100 Mm / 150 Mm
- Applications: Hotel / School / Residence / Office / Bathroom
- Highlight: 220v inline duct fans, 220v inline extractor fan



#### More Images



## Product Description

### Product Overview

Revolutionize air circulation in expansive industrial and commercial facilities with our precision-engineered **Positive Pressure Ceiling Exhaust System**. Designed for demanding environments, this advanced unit rapidly evacuates stale air while maintaining controlled fresh air infusion, ensuring optimal IAQ (Indoor Air Quality) in warehouses, factories, and large-scale complexes. Its corrosion-resistant architecture and energy-optimized airflow dynamics make it indispensable for sectors prioritizing hygiene, safety, and operational continuity.

### Core Innovations

#### Fire-Safe Engineering

**Material Integrity:** Full-metal construction using fire-retardant aluminum alloys (ASTM E84 Class A rated) prevents combustion spread.

**Compliance:** Meets NFPA 96 and UL 705 standards for commercial ventilation safety.

#### High-Static Pressure Performance

Aerodynamically optimized impeller blades and reinforced housing sustain static pressures up to **1,200 Pa**, ideal for duct networks exceeding 50 meters.

CFD-tested airflow paths reduce turbulence, boosting efficiency by 35% versus conventional models.

#### Industrial-Grade Motor System

**Zero-Maintenance Operation:** German-engineered SKF ball bearings with lifetime lubrication, paired with thermal overload cutoffs, ensure 80,000+ hours of continuous runtime.

**Noise Control:** Sound-dampened motor mounts and vortex-shell acoustics limit operational noise to **≤55 dB(A)** at 1 meter.

#### Smart Integration Ready

Pre-wired for IoT sensors (humidity, CO<sub>2</sub>, VOC monitoring) to enable automated ventilation adjustments via BACnet or Modbus protocols.

## General assembly Drawing

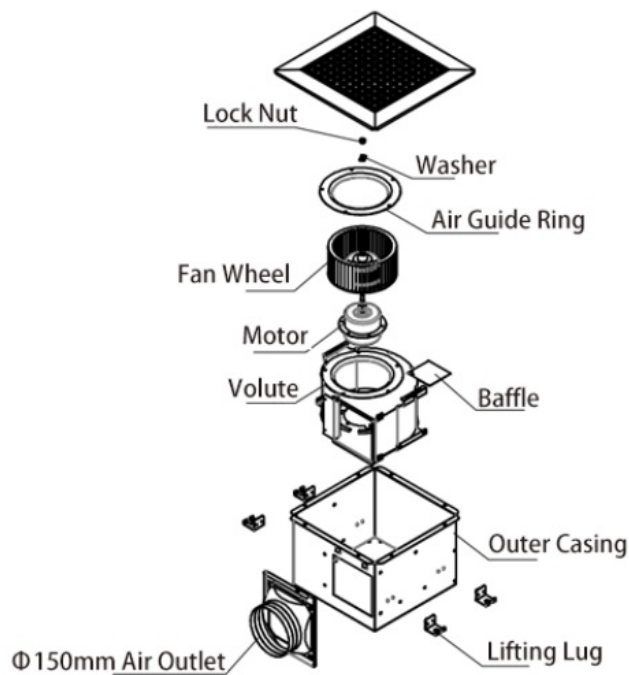

## Product Installation Method

### Phase 1: Structural Framework

Assemble a galvanized steel frame (minimum thickness: 2.5 mm) anchored to ceiling joists using M12 seismic-grade bolts (torque: 45 Nm).

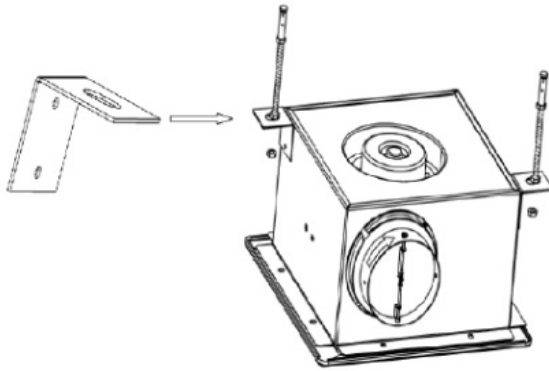

### Phase 2: Unit Mounting

Secure the enclosure to the frame via vibration-isolating neoprene pads (compression rating: 15 psi) to minimize harmonic resonance.

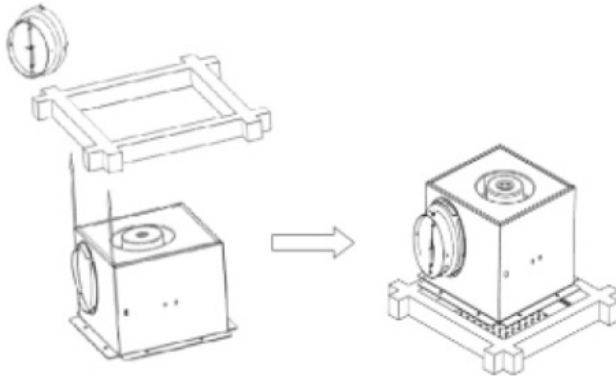

### Phase 3: Ductwork Interface

Align the flange-mounted duct adapter with the laser-etched airflow indicator (→), then engage the quadruple-lock mechanism for an airtight ISO 7/3-rated seal.

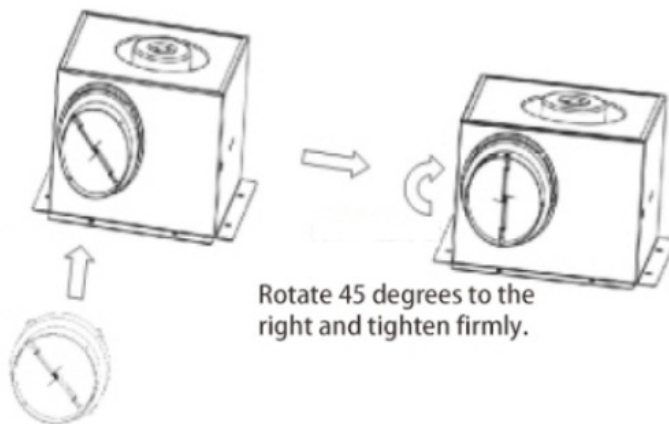

Rotate 45 degrees to the right and tighten firmly.

Fasten the air duct interface to the air inlet and outlet.

## Product Performance Curve

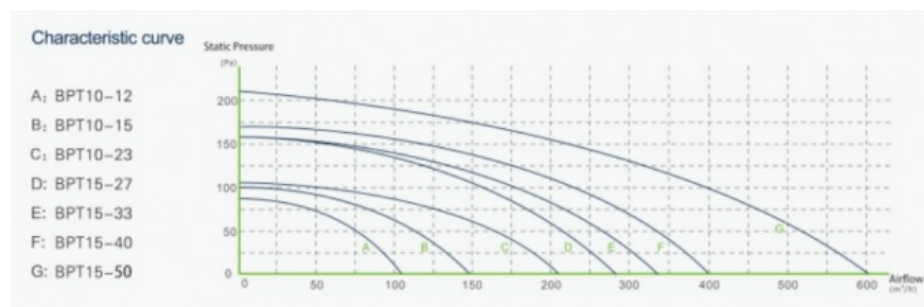

### Product Performance Specifications

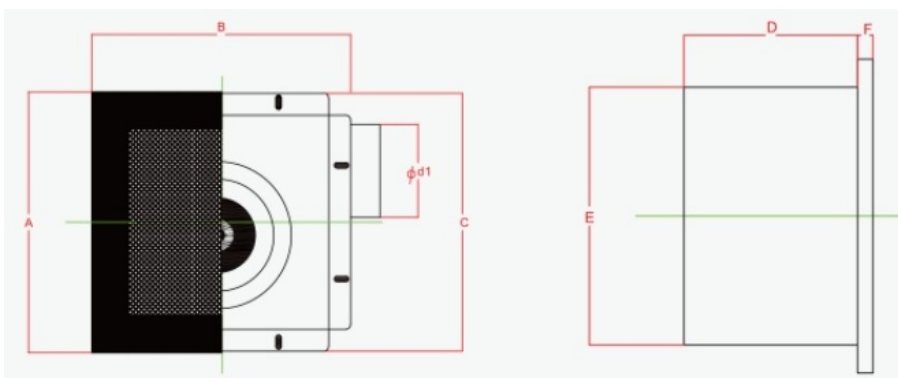

Model Num	A	B	C	D	E	F	Cutout Dimensions
BPT10-12	280	280	277	155	230	14	230*240
BPT10-15	280	280	277	155	230	14	230*240
BPT10-21	280	280	277	155	230	14	230*240
BPT15-27	380	380	341	224	306	14	306*306
BPT15-33	380	380	341	224	306	14	306*306
BPT15-40	380	380	341	224	306	14	306*306
BPT15-60	380	380	341	224	306	14	306*306

 **ZhongDian** Guangdong Zhongdian Jiajin Environmental Technology Co., Ltd.

 0085246403891

 sales001@zd-fan.com

 zd-fan.com

Xizi Industrial Zone, Lishui Town, Nanhai District, Foshan City, Guangdong Province, China