

Full Metal Case Ceiling Duct Ventilation Tubular Exhaust Fan

Our Product Introduction

for more products please visit us on zd-fan.com

Basic Information

- Place of Origin: China Foshan
- Brand Name: Available for ODM
- Certification: CE
- Model Number: BPT10-12
- Minimum Order Quantity: 1
- Price: Contact Us
- Packaging Details: Carton packaging 1 units per carton
- Delivery Time: 3-8 work days
- Payment Terms: T/T
- Supply Ability: 5000



Product Specification

- Type: Axial Flow Fan
- Applicable Industries: Hotels, Building Material Shops, Home Use, Retail, Construction Works
- Mounting: Ceiling Mounting
- Motor: Capacitor Copper Wire Motor
- Noise: MAX 45 DB
- Voltage (V): 220V
- Air Flow: 120-500 M³/h
- Highlight: ventilation inline duct fans, ventilation inline extractor fan, 220v inline duct fans



More Images

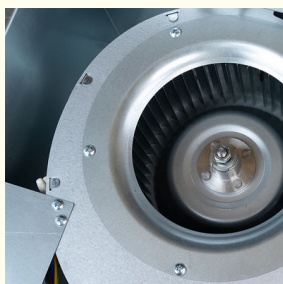

Product Description

Product Overview

High-performance ventilation units efficiently extract moisture-saturated air from high-humidity zones, including bathrooms, laundry rooms, restrooms, and indoor swimming pools. Engineered with scalable airflow capacities, these systems adapt seamlessly to spaces of all sizes—from compact residential washrooms to expansive commercial pool enclosures.

Available in versatile configurations such as direct-mounted exhaust fans and duct-integrated in-line models, all variants prioritize a singular objective: redirecting excess humidity outdoors via ductwork to maintain balanced indoor air quality.

Key Advantages

Premium Construction: Full-metal housing ensures durability and simplifies integration with air outlets.

Reliable Performance: Capacitor-driven motor guarantees extended operational lifespan with minimal maintenance.

Safety Assurance: Built-in thermal overload protector prevents overheating, enhancing user safety.

Adaptive Design: Compatible with ceiling-mounted installations and duct/pipe connectivity, enabling streamlined installation and maintenance.

User-Centric Features: Pre-adjusted mounting brackets and tool-free access panels simplify cleaning and servicing.

General assembly Drawing

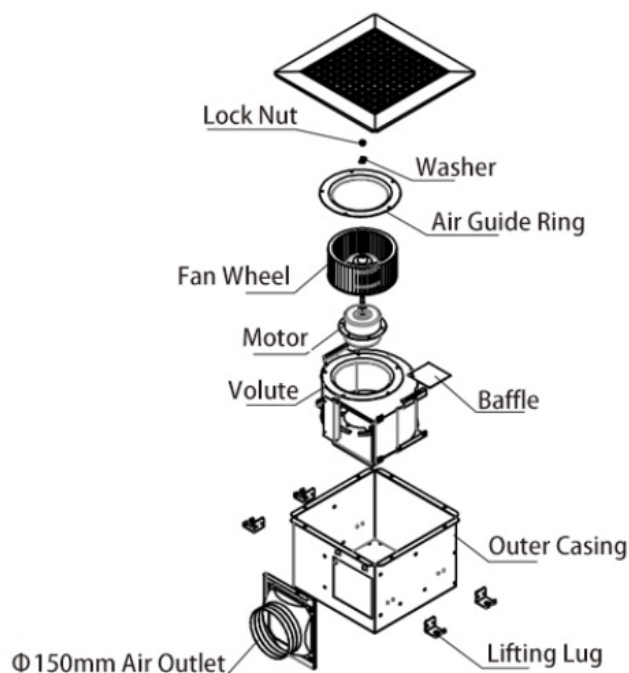

Product Installation Method

Step 1: Construct a rigid ceiling-mounted frame using corrosion-resistant materials, ensuring structural stability.

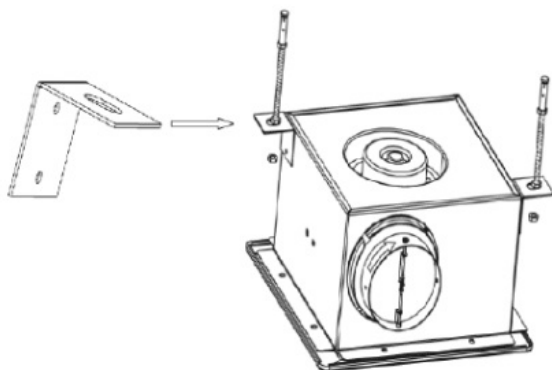

Step 2: Attach the fan enclosure or housing unit to the pre-assembled frame, securing it with vibration-dampening fasteners.

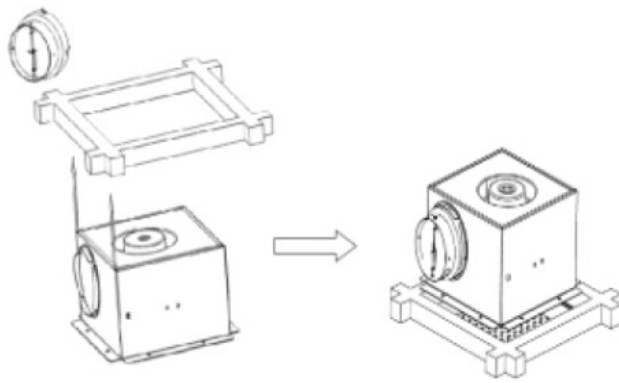

Step 3: Align the duct connector with the directional arrow (indicating airflow path) and lock it onto the cabinet's exhaust port using a twist-to-lock system for airtight sealing.

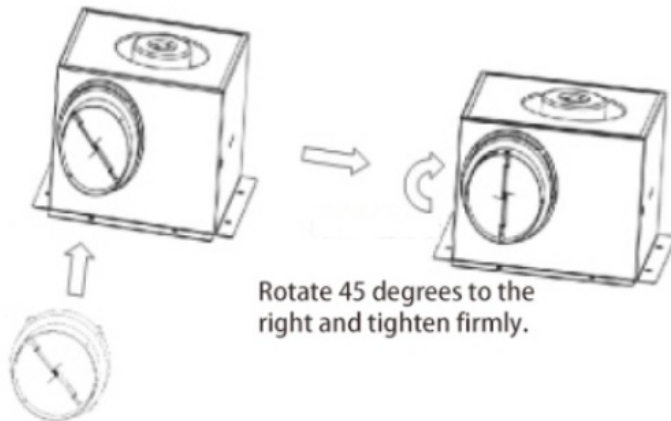

Rotate 45 degrees to the right and tighten firmly.

Fasten the air duct interface to the air inlet and outlet.

Product Performance Curve

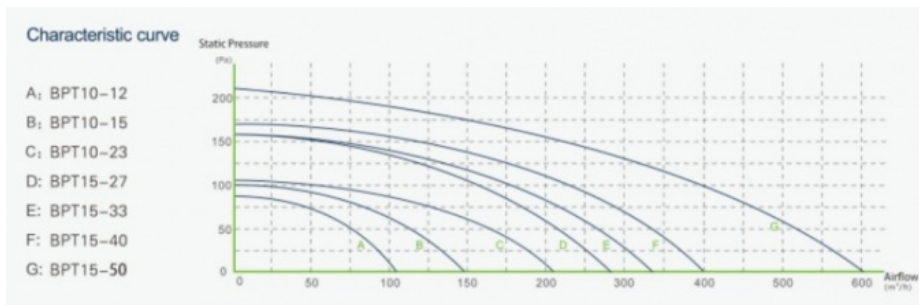

Product Performance Specifications

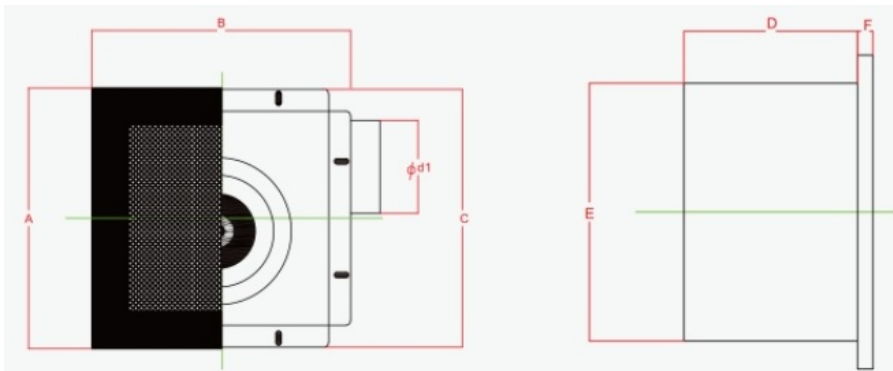

Model Num	A	B	C	D	E	F	Cutout Dimensions
BPT10-12	280	280	277	155	230	14	230*240
BPT10-15	280	280	277	155	230	14	230*240
BPT10-21	280	280	277	155	230	14	230*240

BPT15-27	380	380	341	224	306	14	306*306
BPT15-33	380	380	341	224	306	14	306*306
BPT15-40	380	380	341	224	306	14	306*306
BPT15-60	380	380	341	224	306	14	306*306

 **ZhongDian** **Guangdong Zhongdian Jiajin Environmental Technology Co., Ltd.**



0085246403891



sales001@zd-fan.com



zd-fan.com

Xizi Industrial Zone, Lishui Town, Nanhai District, Foshan City, Guangdong Province, China