

Powerful and Easy-to-Install Inline Duct Fans for Effective Moisture Elimination in Bathrooms and More

Our Product Introduction

for more products please visit us on zd-fan.com

Basic Information

- Place of Origin: China Foshan
- Brand Name: Available for ODM
- Certification: CE
- Model Number: BPT10-12
- Minimum Order Quantity: 1
- Price: Contact Us
- Packaging Details: Carton packaging 1 units per carton
- Delivery Time: 3-8 work days
- Payment Terms: T/T
- Supply Ability: 5000



Product Specification

- Function: Ceiling Duct Air Flow
- Mounting: Ceiling
- Voltage: 220V
- Power: 24-100W
- Air Volume: 120-600 M³/h
- Core Components: Motor, Engine
- Noise: 32-58 DB
- Static Pressure(Pa): 80-220 Pa
- Motor: 100% Copper Coil
- Duct Size: 100 Mm / 150 Mm
- Applications: Hotel / School / Residence / Office / Bathroom
- Usage: Ventilation
- Material: Galvanized Steel
- Type: Duct Fan



More Images

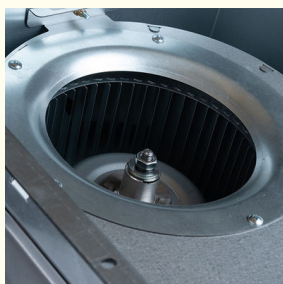

Product Description

Product Overview

Modern extraction systems efficiently remove moisture-laden air from humid environments such as bathrooms, laundry rooms, and indoor pool areas. Designed to accommodate varying spatial requirements, these units are available in a range of airflow capacities—ideal for both confined washrooms and large-scale residential or commercial settings.

Multiple configurations are offered, including compact exhaust fans and concealed in-line ventilation systems. While installation methods may differ, all models share a unified purpose: redirecting humid air outdoors via connected ductwork to maintain optimal indoor air quality.

Key Features & Benefits

Aesthetic Appeal: Sleek, modern grille aesthetics complement contemporary interiors.

Robust Build: Galvanized steel housing ensures corrosion resistance and long-term durability.

User-Friendly Installation: Simplified setup with intuitive mounting guidelines.

Adaptable Mounting: Adjustable brackets (spanning up to 24") enable flexible placement across ceiling structures.

Safety Enhancement: Built-in backdraft damper prevents air backflow, ensuring unidirectional airflow.

General assembly Drawing

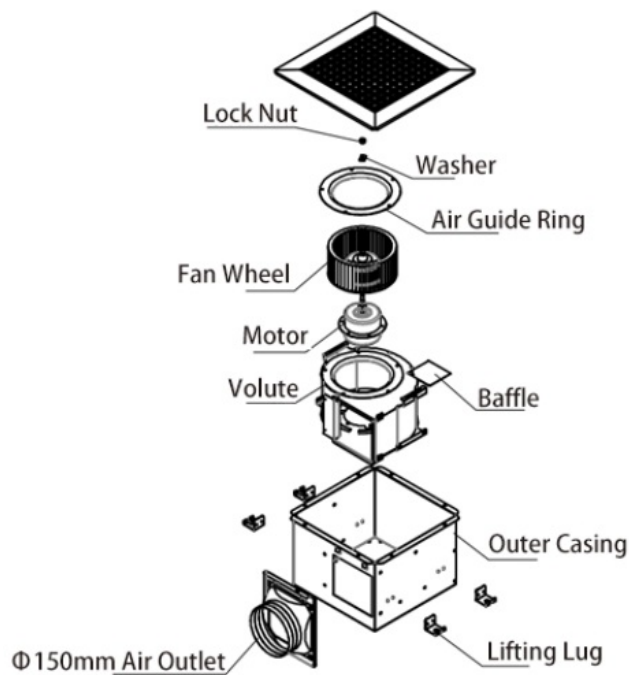

Product Installation Method

Step 1: Construct a rigid rectangular framework and securely fasten it to the ceiling substrate.

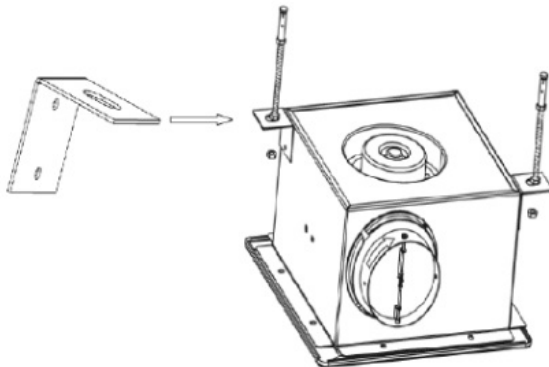

Step 2: Attach the fan enclosure or storage unit to the preassembled frame using manufacturer-recommended fixtures.

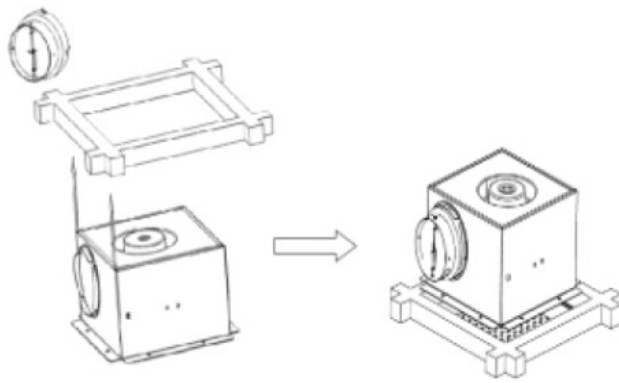

Step 3: Align the duct connector with the airflow directional indicator (marked by an arrow) and lock it into the cabinet's exhaust port via a twist-and-seal mechanism to guarantee airtight linkage.

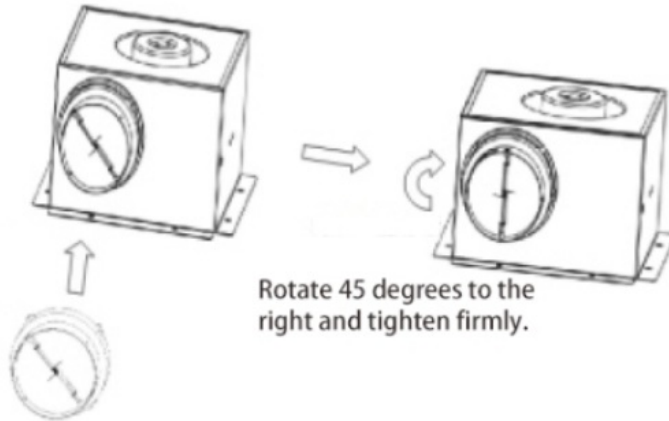

Fasten the air duct interface to the air inlet and outlet.

Product Performance Curve

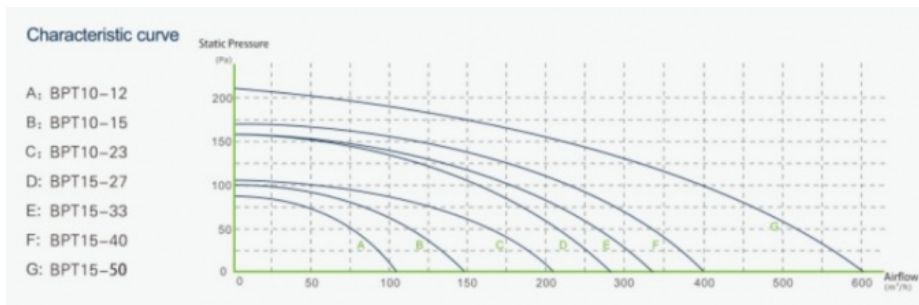

Product Performance Specifications

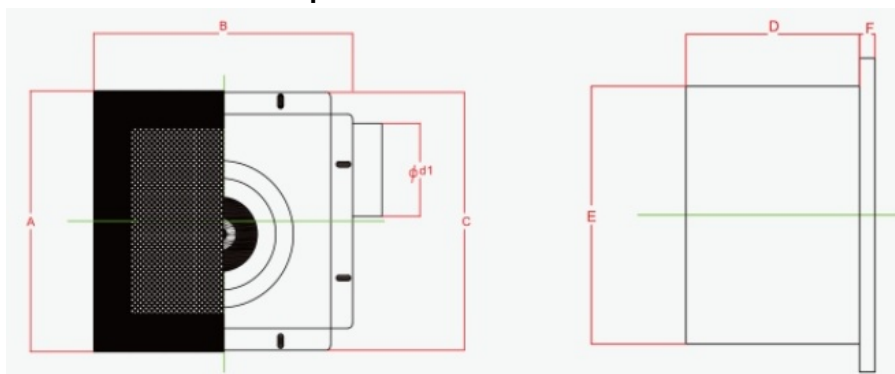

Model Num	A	B	C	D	E	F	Cutout Dimensions
BPT10-12	280	280	277	155	230	14	230*240
BPT10-15	280	280	277	155	230	14	230*240
BPT10-21	280	280	277	155	230	14	230*240

BPT15-27	380	380	341	224	306	14	306*306
BPT15-33	380	380	341	224	306	14	306*306
BPT15-40	380	380	341	224	306	14	306*306
BPT15-60	380	380	341	224	306	14	306*306

 **ZhongDian** **Guangdong Zhongdian Jiajin Environmental Technology Co., Ltd.**



0085246403891



sales001@zd-fan.com



zd-fan.com

Xizi Industrial Zone, Lishui Town, Nanhai District, Foshan City, Guangdong Province, China