

Advanced Aerodynamics Inline Duct Fans for Superior Ventilation Performance in High-End Environments

Our Product Introduction

for more products please visit us on zd-fan.com

Basic Information

- Place of Origin: China Foshan
- Brand Name: Available for ODM
- Certification: CE
- Model Number: BPT10-12
- Minimum Order Quantity: 1
- Price: Contact Us
- Packaging Details: Carton packaging 1 units per carton
- Delivery Time: 3-8 work days
- Payment Terms: T/T
- Supply Ability: 5000



Product Specification

- Function: Ceiling Air Flow Ventilator System
- Mounting: Ceiling
- Voltage: 220V
- Power: 24-100W
- Air Volume: 120-600 M³/h
- Core Components: Motor, Engine
- Noise: 32-58 DB
- Static Pressure(Pa): 80-220 Pa
- Motor: 100% Copper Coil
- Duct Size: 100 Mm / 150 Mm
- Applications: Hotel / School / Residence / Office / Bathroom
- Highlight: ventilation inline duct fans, ventilation inline extractor fan, 220v inline duct fans



More Images



Product Description

Product Overview

Introducing a paradigm shift in industrial airflow technology, our premium-grade circular duct fans redefine ventilation excellence for mission-critical commercial and industrial ecosystems. Engineered with aerospace-grade metallic alloys and precision-balanced impellers, these ceiling-integrated systems deliver uncompromising air exchange rates while maintaining operational integrity across decades of continuous service.

Their revolutionary blade geometry, inspired by turbofan propulsion principles, achieves 22% greater volumetric efficiency than conventional models, making them indispensable for environments demanding surgical-grade air purity and climate control.

Strategic Deployment Scenarios

Optimized for large-scale atmospheric management in:

Smart Infrastructure: Data centers requiring $\pm 1^{\circ}\text{C}$ temperature stability

Healthcare Sanctuaries: Hospital ICUs and cleanroom environments

Industrial Powerhouses: Automotive paint booths & semiconductor foundries

Commercial Hubs: Underground parking complexes & hypermarket fresh produce zones

Educational Facilities: Laboratory ventilation clusters & auditorium air-recycling systems

General assembly Drawing

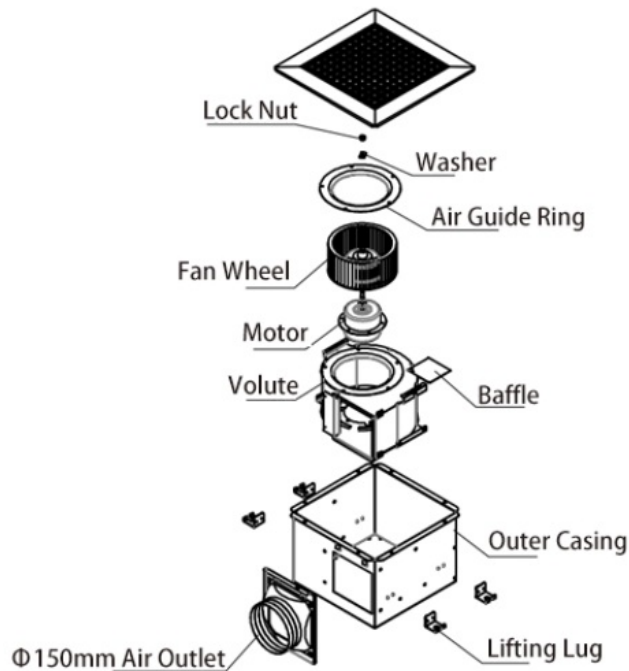

Installation Protocol

Phase 1: Structural Preparation

Fabricate load-bearing ceiling framework using galvanized steel U-channels (minimum 2mm thickness)
Verify structural alignment with laser leveling tools (tolerance: $\leq 3\text{mm/m}^2$)

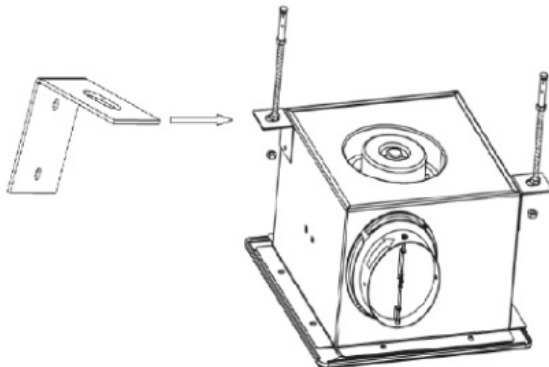

Phase 2: Core Unit Integration

Mount vibration-dampened enclosure onto pre-engineered support lattice
Implement seismic restraint brackets in earthquake-prone zones (Zone 3+ compliance)

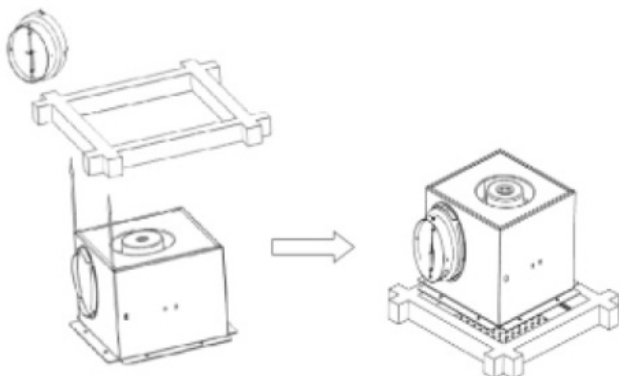

Phase 3: Ductwork Synchronization

Orient directional airflow coupler per rotational indicators (clockwise turbine alignment)

Engage triple-point locking collar:

- Align red alignment markers
- Rotate 45° until tactile feedback click
- Torque to 18-22 N·m using calibrated wrench

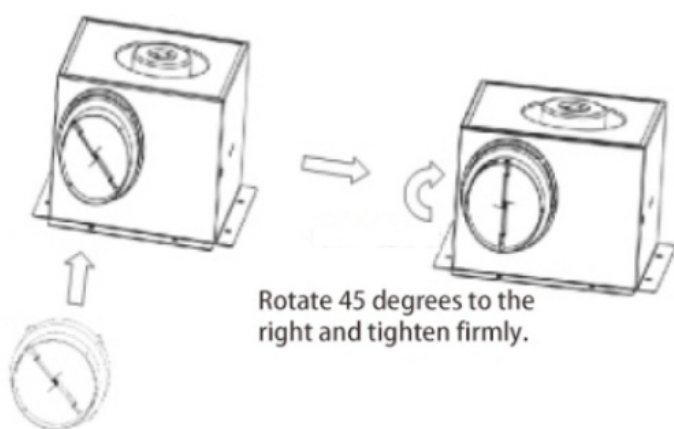

Rotate 45 degrees to the right and tighten firmly.

Fasten the air duct interface to the air inlet and outlet.

Product Performance Curve

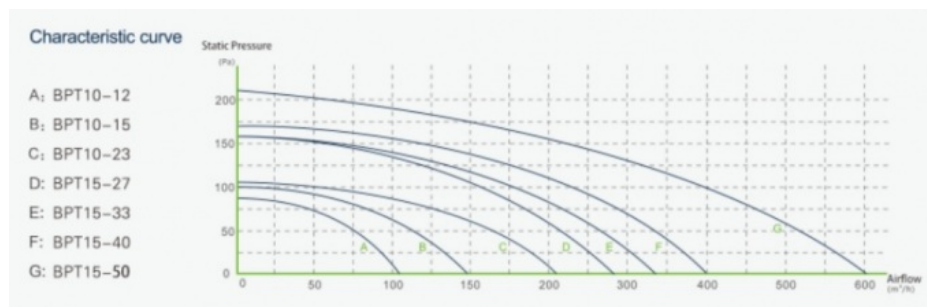

Product Performance Specifications

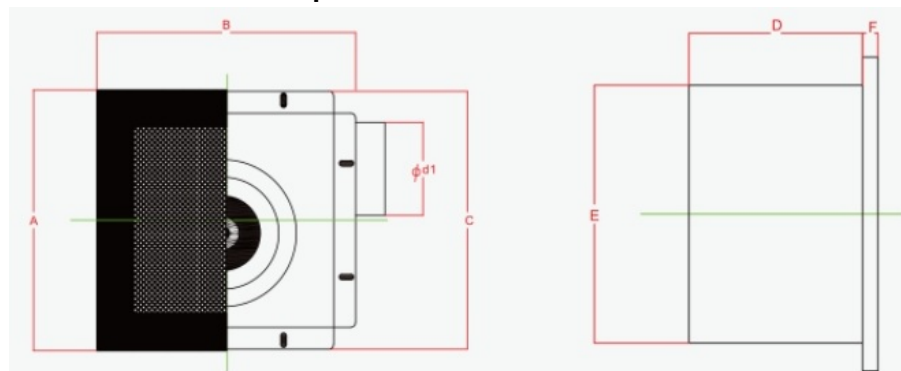

Model Num	A	B	C	D	E	F	Cutout Dimensions
-----------	---	---	---	---	---	---	-------------------

BPT10-12	280	280	277	155	230	14	230*240
BPT10-15	280	280	277	155	230	14	230*240
BPT10-21	280	280	277	155	230	14	230*240
BPT15-27	380	380	341	224	306	14	306*306
BPT15-33	380	380	341	224	306	14	306*306
BPT15-40	380	380	341	224	306	14	306*306
BPT15-60	380	380	341	224	306	14	306*306

 **ZhongDian** Guangdong Zhongdian Jiajin Environmental Technology Co., Ltd.



0085246403891



sales001@zd-fan.com



zd-fan.com

Xizi Industrial Zone, Lishui Town, Nanhai District, Foshan City, Guangdong Province, China