

## Mute Metal Case Ventilation Powerful Exhaust Ceiling Air Flow Fan

Our Product Introduction

for more products please visit us on [zd-fan.com](http://zd-fan.com)

### Basic Information

- Place of Origin: China Foshan
- Brand Name: Available for ODM
- Certification: CE
- Model Number: BPT10-12
- Minimum Order Quantity: 1
- Price: Contact Us
- Packaging Details: Carton packaging 1 units per carton
- Delivery Time: 3-8 work days
- Payment Terms: T/T
- Supply Ability: 5000



### Product Specification

- Type: Ceiling Mounted Fan
- Applicable Industries: Hotels, Building Material Shops, Home Use, Retail, Construction Works
- Mounting: Ceiling Mounted
- Motor: Capacitor Copper Wire Motor
- Noise: MAX 45 DB
- Voltage (V): 220V
- Air Flow: 120-500 M³/h
- MOQ: 30 Set
- Highlight: ventilation inline duct fans, ventilation inline extractor fan, 220v inline duct fans



### More Images



## Product Description

### Product Overview

Engineered for moisture control, our extraction fans are designed to efficiently manage humidity in bathrooms, laundry areas, restrooms, and other high-moisture zones. With scalable capacities, these units cater to spaces of all sizes—from compact washrooms to expansive indoor pool enclosures. Available in both exhaust and inline configurations, the core function remains consistent: redirecting moisture-laden air outdoors via ductwork to maintain optimal indoor air quality.

#### Key Advantages

##### Robust Build & Simplified Installation

A full-metal housing ensures durability while streamlining the integration of air outlets. Pre-fabricated mounting brackets enable effortless ceiling installation and seamless alignment with existing duct systems.

##### High-Performance Capacitor Motor

Equipped with a capacitor-enhanced motor, the fan delivers reliable operation with extended service life, reducing maintenance needs.

##### Advanced Safety Features

Overheat protection safeguards against electrical faults, ensuring continuous, risk-free performance in demanding environments.

##### Modular Design for Maintenance

The twist-lock duct connector and tool-free assembly allow quick access for cleaning or part replacement, minimizing downtime.

## General assembly Drawing

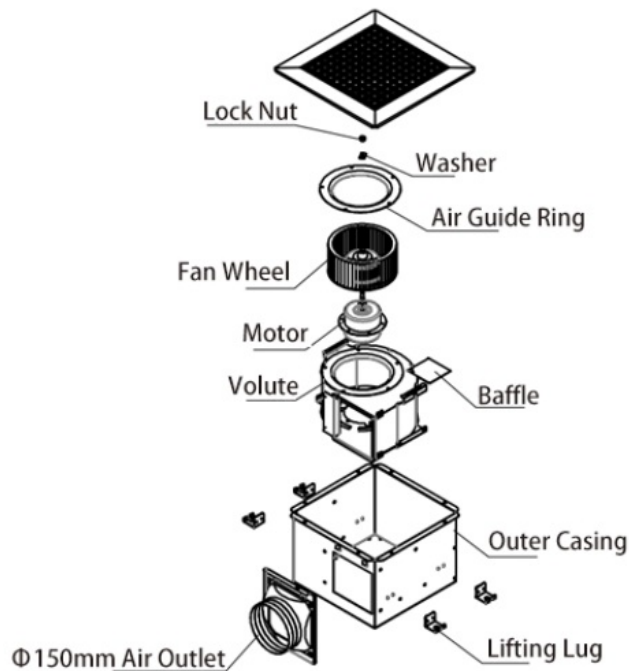

#### Installation Protocol

##### Step 1: Structural Frame Assembly

Construct a reinforced rectangular frame using load-bearing anchors, ensuring it is rigidly fixed to ceiling joists for stability.

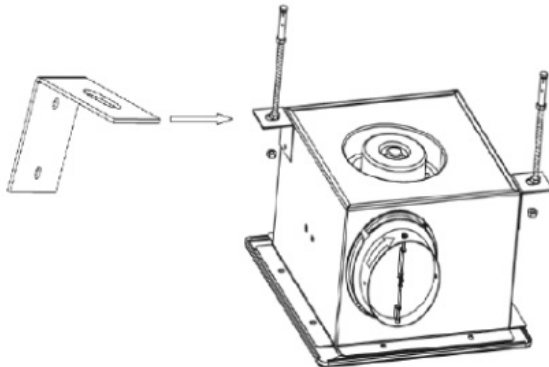

##### Step 2: Unit Securement

Mount the fan enclosure onto the pre-installed frame using anti-vibration fasteners to reduce operational noise and enhance longevity.

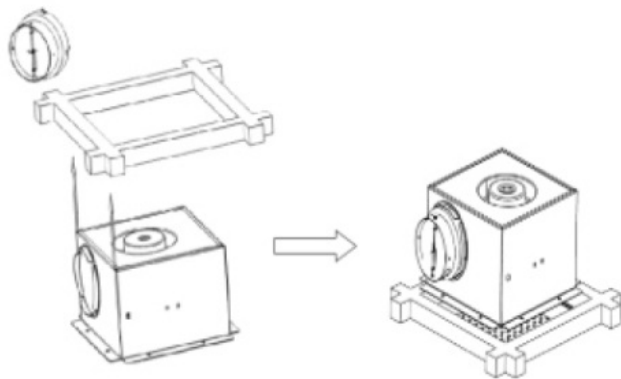

### Step 3: Ductwork Alignment

Orient the ventilation duct connector according to the directional arrow marked on the unit. Engage the bayonet-style locking mechanism to the cabinet's air outlet port, guaranteeing airtight connectivity and optimal airflow efficiency.

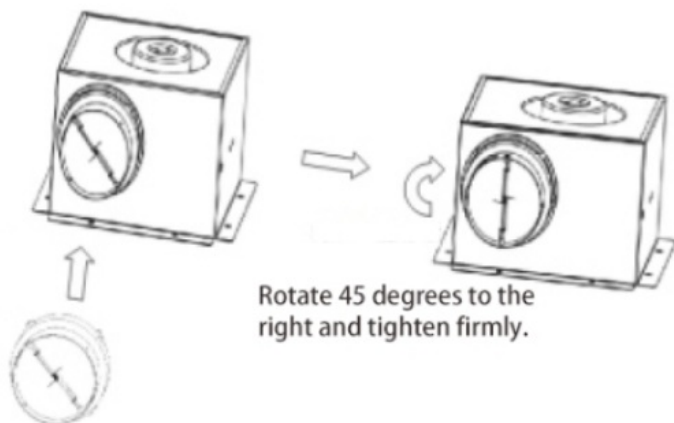

Rotate 45 degrees to the right and tighten firmly.

Fasten the air duct interface to the air inlet and outlet.

## Product Performance Curve

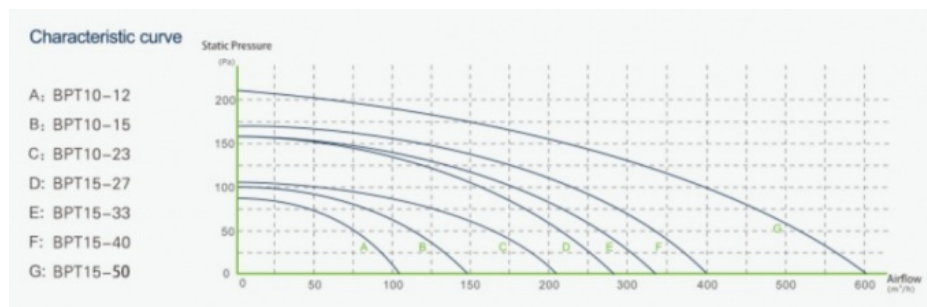

## Product Performance Specifications

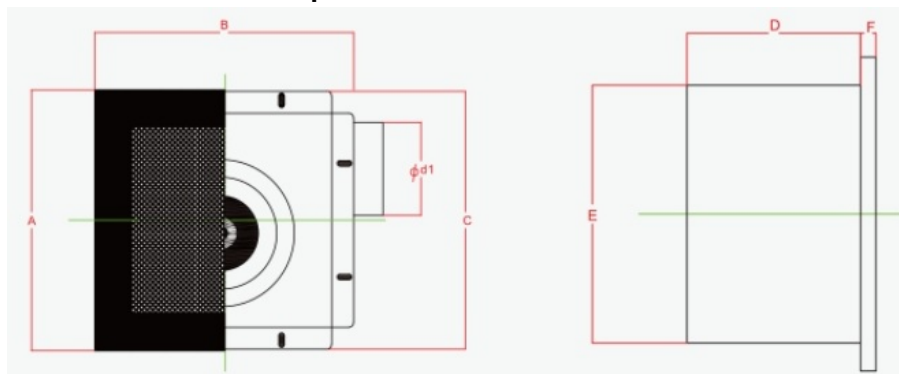

Model Num	A	B	C	D	E	F	Cutout Dimensions
BPT10-12	280	280	277	155	230	14	230*240
BPT10-15	280	280	277	155	230	14	230*240
BPT10-21	280	280	277	155	230	14	230*240

BPT15-27	380	380	341	224	306	14	306*306
BPT15-33	380	380	341	224	306	14	306*306
BPT15-40	380	380	341	224	306	14	306*306
BPT15-60	380	380	341	224	306	14	306*306

 **ZhongDian** **Guangdong Zhongdian Jiajin Environmental Technology Co., Ltd.**



0085246403891



sales001@zd-fan.com



zd-fan.com

Xizi Industrial Zone, Lishui Town, Nanhai District, Foshan City, Guangdong Province, China