

## Innovative Inline Duct Fans with Adjustable Mounting Brackets and Backdraft Damper for Enhanced Safety

Our Product Introduction

for more products please visit us on [zd-fan.com](http://zd-fan.com)

### Basic Information

- Place of Origin: China Foshan
- Brand Name: Available for ODM
- Certification: CE
- Model Number: BPT10-12
- Minimum Order Quantity: 1
- Price: Contact Us
- Packaging Details: Carton packaging 1 units per carton
- Delivery Time: 3-8 work days
- Payment Terms: T/T
- Supply Ability: 5000



### Product Specification

- Function: Ceiling Duct Air Flow
- Mounting: Ceiling
- Voltage: 220V
- Power: 24-100W
- Air Volume: 120-600 M³/h
- Core Components: Motor, Engine
- Noise: 32-58 DB
- Static Pressure(Pa): 80-220 Pa
- Motor: 100% Copper Coil
- Duct Size: 100 Mm / 150 Mm
- Applications: Hotel / School / Residence / Office / Bathroom
- Usage: Ventilation
- Material: Galvanized Steel
- Type: Duct Fan



### More Images

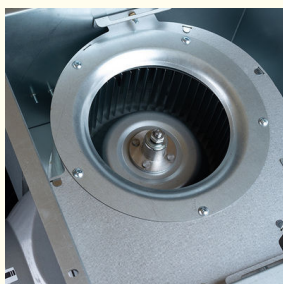

## Product Description

### Product Overview

Engineered to combat excess moisture, our extraction fans efficiently regulate air quality in bathrooms, laundry rooms, washrooms, and enclosed pool areas. Designed in varied capacities, they adapt seamlessly to spaces ranging from compact powder rooms to large-scale humidity-prone zones.

Available as exhaust ventilation units or inline duct-mounted systems, all models share a unified purpose: channeling damp air outdoors via ductwork to maintain balanced indoor humidity levels.

### Key Features & Benefits

#### Sleek Grille with Minimalist Styling

Aesthetically pleasing and aerodynamically optimized to blend into modern interiors.

#### Robust Galvanized Steel Housing

Corrosion-resistant construction ensures longevity in high-moisture environments.

#### User-Friendly Installation

Pre-assembled components and intuitive mounting brackets (adjustable up to 24") simplify setup.

#### Built-In Backdraft Damper

Automatically blocks reverse airflow to maintain system efficiency and safety.

#### Tool-Free Duct Connectivity

Twist-lock duct connectors enable rapid, secure attachment without specialized equipment.

## General assembly Drawing

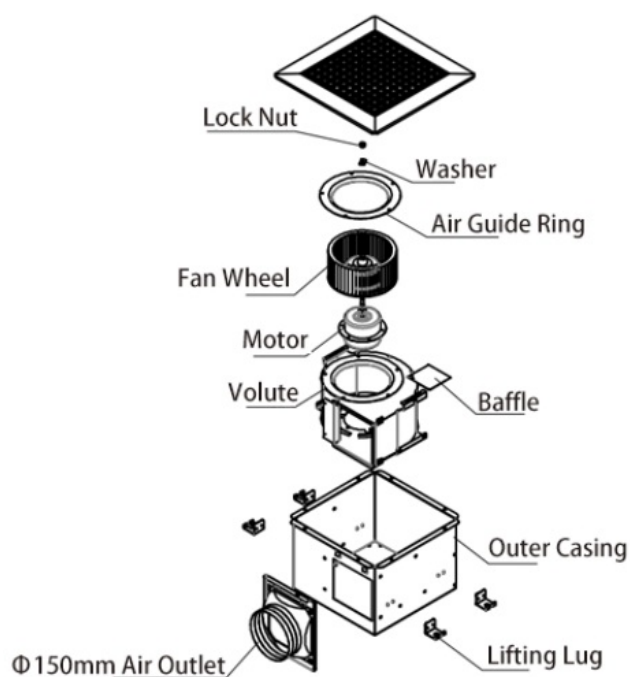

## Product Installation Method

### Step 1: Frame Preparation

Construct a structural-grade rectangular frame using joist-mounted anchors to ensure ceiling stability.

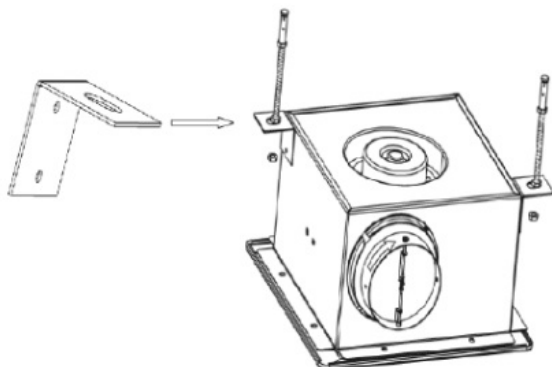

### Step 2: Unit Integration

Secure the fan enclosure to the pre-installed framework using vibration-dampening fasteners.

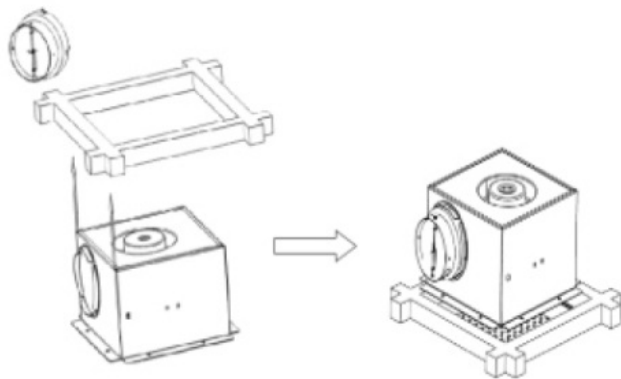

### Step 3: Directional Duct Alignment

Align the duct collar's directional arrow with airflow requirements, then lock it to the cabinet outlet using quick-connect bayonet fittings.

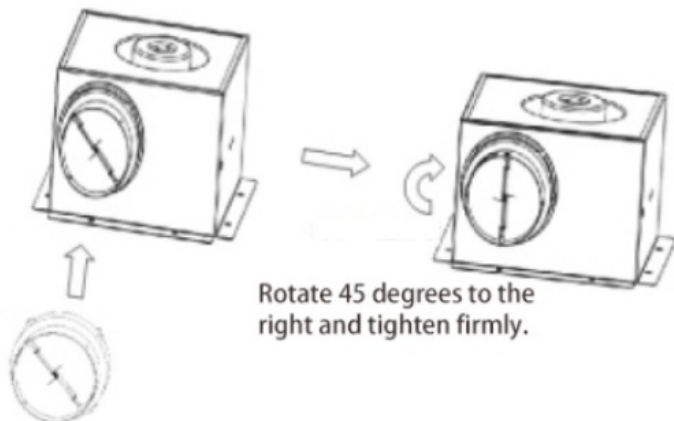

Rotate 45 degrees to the right and tighten firmly.

Fasten the air duct interface to the air inlet and outlet.

## Product Performance Curve

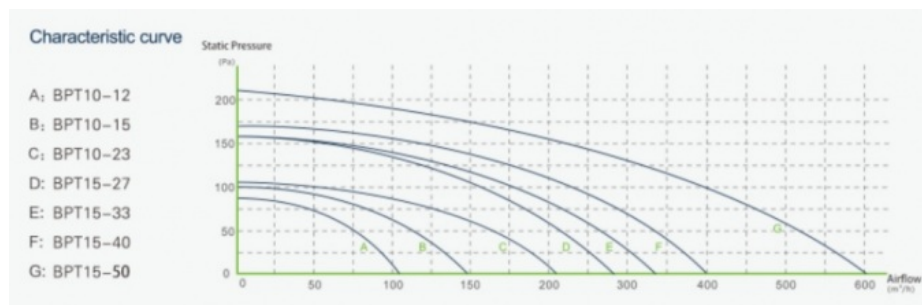

## Product Performance Specifications

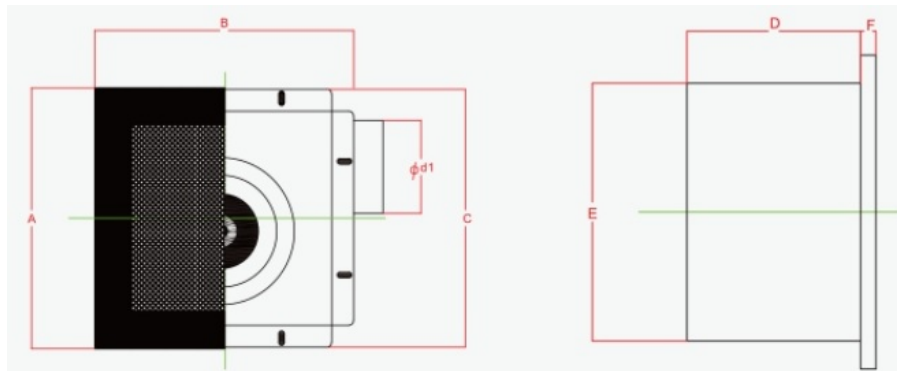

Model Num	A	B	C	D	E	F	Cutout Dimensions
BPT10-12	280	280	277	155	230	14	230*240
BPT10-15	280	280	277	155	230	14	230*240
BPT10-21	280	280	277	155	230	14	230*240

BPT15-27	380	380	341	224	306	14	306*306
BPT15-33	380	380	341	224	306	14	306*306
BPT15-40	380	380	341	224	306	14	306*306
BPT15-60	380	380	341	224	306	14	306*306

 **ZhongDian** **Guangdong Zhongdian Jiajin Environmental Technology Co., Ltd.**



0085246403891



sales001@zd-fan.com



zd-fan.com

Xizi Industrial Zone, Lishui Town, Nanhai District, Foshan City, Guangdong Province, China