

Full Metal Case Ceiling Duct Pipe Tubular Ceiling Mount Bathroom Ventilation Exhaust Fan

Our Product Introduction

for more products please visit us on zd-fan.com

Basic Information

- Place of Origin: China Foshan
- Brand Name: Available for ODM
- Certification: CE
- Model Number: BPT10-12
- Minimum Order Quantity: 1
- Price: Contact Us
- Packaging Details: Carton packaging 1 units per carton
- Delivery Time: 3-8 work days
- Payment Terms: T/T
- Supply Ability: 5000



Product Specification

- Function: Ceiling Air Flow Ventilator System
- Mounting: Ceiling
- Voltage: 220V
- Power: 24-100W
- Air Volume: 120-600 M³/h
- Core Components: Motor, Engine
- Noise: 32-58 DB
- Static Pressure(Pa): 80-220 Pa
- Motor: 100% Copper Coil
- Duct Size: 100 Mm / 150 Mm
- Applications: Hotel / School / Residence / Office / Bathroom
- Highlight: Bathroom Ventilation Exhaust Fan, Tubular Ceiling Mount Exhaust Fan



More Images

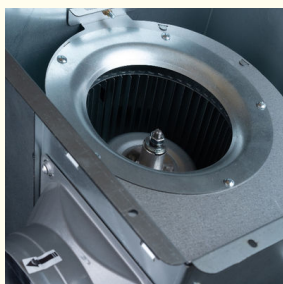

Product Description

Product Overview

Discover the ultimate in air management with our ceiling-mounted positive pressure exhaust fan, expertly crafted for vast commercial and industrial settings. This advanced ventilation system excels at swiftly eliminating stagnant air while seamlessly integrating fresh air intake, thereby guaranteeing peak indoor air quality. With its unparalleled efficiency and rugged build, it's the go-to solution for environments that require dependable and effective air circulation solutions.

Advantage

Fire safety	The products are made of all metal material, which meet the requirements of better fire safety.
High static pressure	Superior fan performance and internal structure, to achieve higher static pressure.
High quality motor	The motor adopts high-quality imported ball bearings with low noise and over temperature protection devices,so that the noise is lower and the long-term use is maintenance-free.
Low noise	The flow line of centrifugal fan andvortex shell is optimized, and the key parts are sound-absorbing design, which greatly reduces the noise.

General assembly Drawing

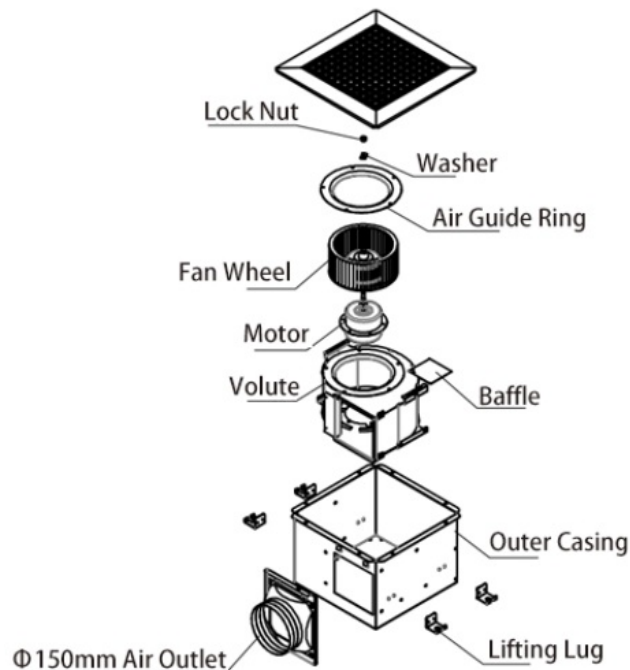

Product Installation Method

1. Begin by building a sturdy rectangular frame, ensuring it is solidly anchored to the ceiling above.

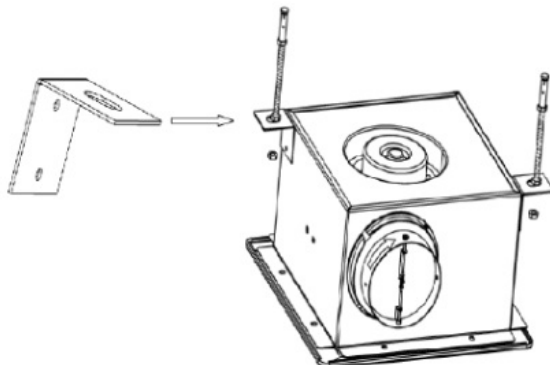

2. Firmly affix the storage unit (or enclosure) to the pre-installed frame.

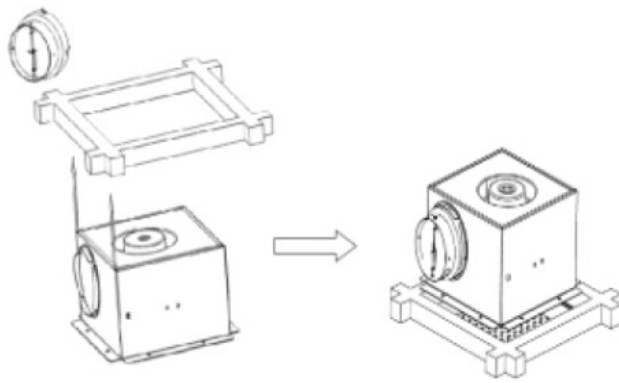

3. Carefully line up the ventilation duct connector with the arrow direction indicated and securely attach it using a twist-lock mechanism to the designated air outlet port on the cabinet, ensuring proper airflow connection.

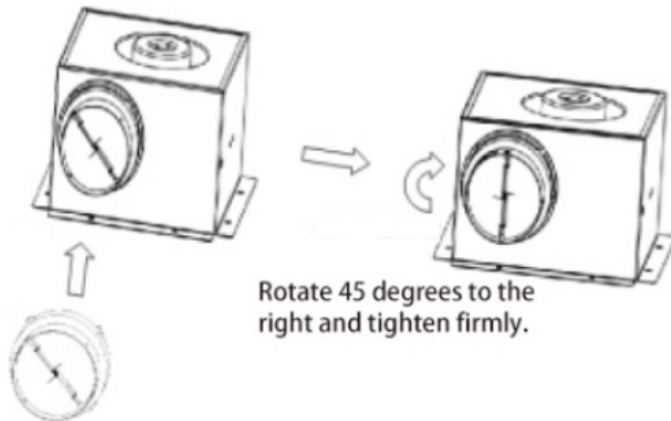

Rotate 45 degrees to the right and tighten firmly.

Fasten the air duct interface to the air inlet and outlet.

Product Performance Curve

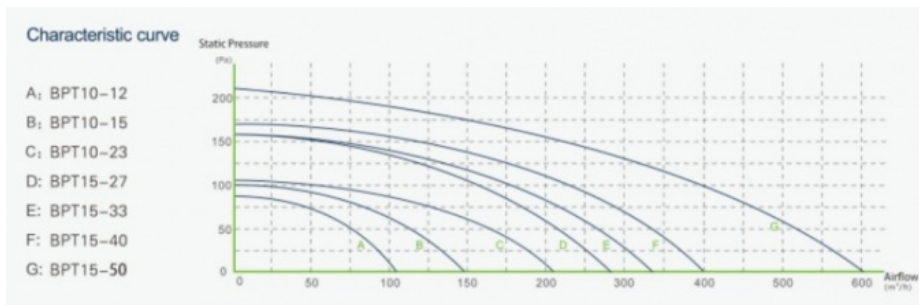

Product Performance Specifications

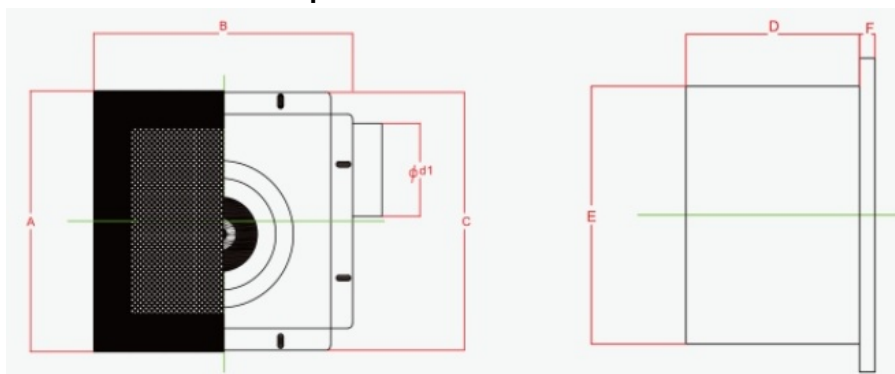

Model Num	A	B	C	D	E	F	Cutout Dimensions
BPT10-12	280	280	277	155	230	14	230*240
BPT10-15	280	280	277	155	230	14	230*240
BPT10-21	280	280	277	155	230	14	230*240

BPT15-27	380	380	341	224	306	14	306*306
BPT15-33	380	380	341	224	306	14	306*306
BPT15-40	380	380	341	224	306	14	306*306
BPT15-60	380	380	341	224	306	14	306*306

 **ZhongDian** **Guangdong Zhongdian Jiajin Environmental Technology Co., Ltd.**



0085246403891



sales001@zd-fan.com



zd-fan.com

Xizi Industrial Zone, Lishui Town, Nanhai District, Foshan City, Guangdong Province, China