

## Positive Pressure Exhaust Fan Fresh Air Extraction Ceiling Mounted Ventilation Systems

Our Product Introduction

for more products please visit us on [zd-fan.com](http://zd-fan.com)

### Basic Information

- Place of Origin: China Foshan
- Brand Name: Available for ODM
- Certification: CE
- Model Number: BPT10-12
- Minimum Order Quantity: 1
- Price: Contact Us
- Packaging Details: Carton packaging 1 units per carton
- Delivery Time: 3-8 work days
- Payment Terms: T/T
- Supply Ability: 5000



### Product Specification

- Function: Ceiling Air Flow Ventilator System
- Mounting: Ceiling
- Voltage: 220V
- Power: 24-100W
- Air Volume: 120-600 M<sup>3</sup>/h
- Core Components: Motor, Engine
- Noise: 32-58 DB
- Static Pressure(Pa): 80-220 Pa
- Motor: 100% Copper Coil
- Duct Size: 100 Mm / 150 Mm
- Applications: Hotel / School / Residence / Office / Bathroom
- Highlight: **Ceiling Mounted Exhaust Fan,  
Fresh Air Extraction Exhaust Fan,  
Positive Pressure Exhaust Fan**



### More Images



## Product Description

### Product Overview

This wholesale positive pressure exhaust fan fresh air extraction ceiling mounted ventilation system is designed for large commercial and industrial environments. It can effectively discharge the dirty air in the room, while introducing fresh air to maintain the indoor air quality. Its efficient ventilation performance and durable design make it ideal for a variety of locations.

### Advantage

**Commercial buildings:** such as shopping malls, supermarkets, office buildings, etc., improve indoor air quality.

**Industrial plant:** eliminate harmful gases and dust to protect the health of workers.

**Public facilities:** such as hospitals, schools, gymnasiums, etc., provide a comfortable environment.

**Other sites:** Various sites requiring efficient ventilation and fresh air extraction.

### General assembly Drawing

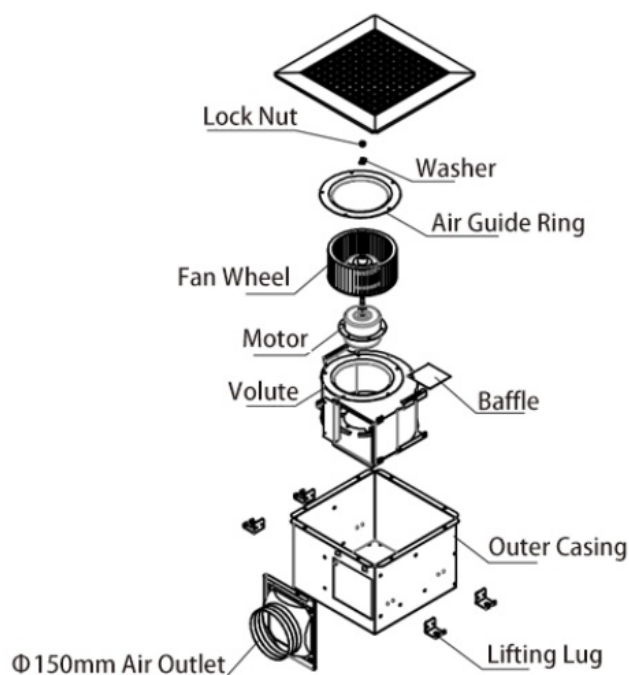

### Product Installation Method

1. Begin by building a sturdy rectangular frame, ensuring it is solidly anchored to the ceiling above.

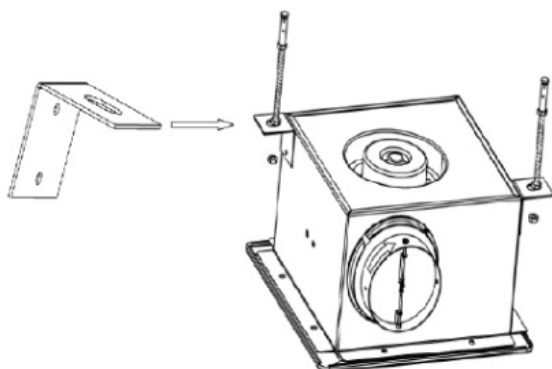

2. Firmly affix the storage unit (or enclosure) to the pre-installed frame.

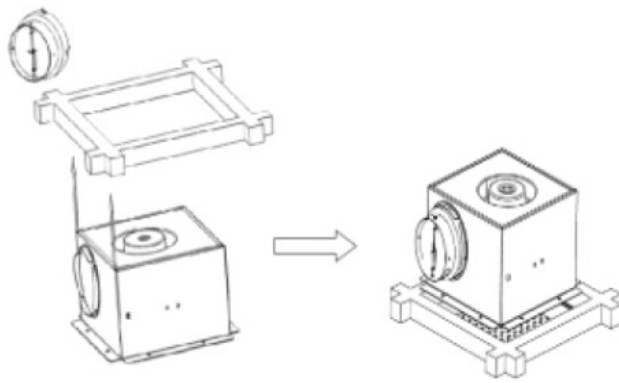

3. Carefully line up the ventilation duct connector with the arrow direction indicated and securely attach it using a twist-lock mechanism to the designated air outlet port on the cabinet, ensuring proper airflow connection.

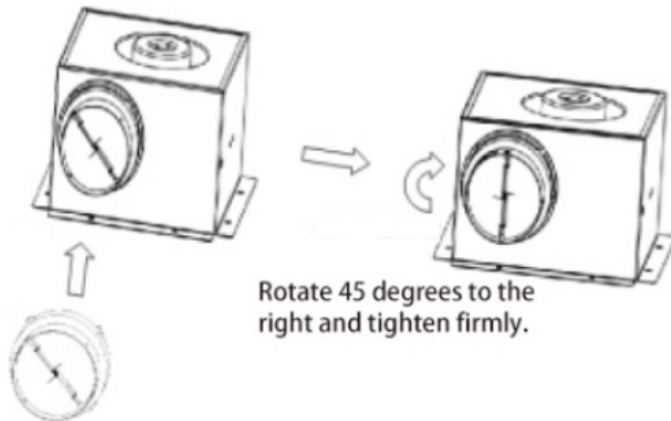

Rotate 45 degrees to the right and tighten firmly.

Fasten the air duct interface to the air inlet and outlet.

## Product Performance Curve

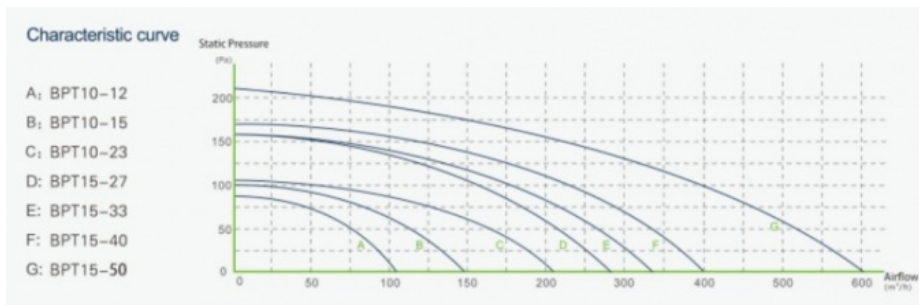

## Product Performance Specifications

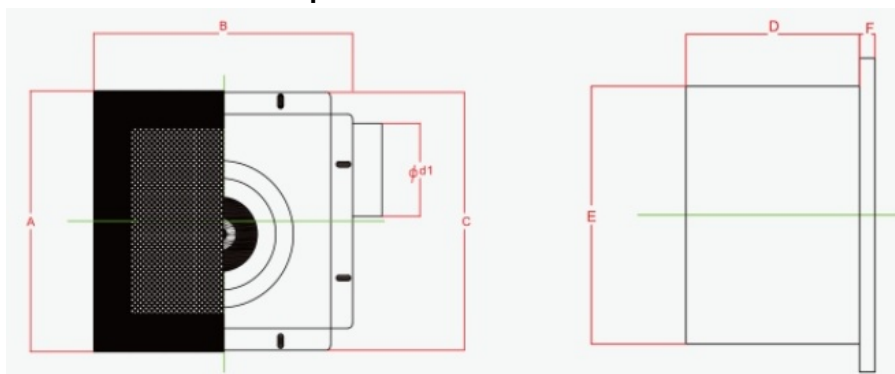

Model Num	A	B	C	D	E	F	Cutout Dimensions
BPT10-12	280	280	277	155	230	14	230*240
BPT10-15	280	280	277	155	230	14	230*240
BPT10-21	280	280	277	155	230	14	230*240

BPT15-27	380	380	341	224	306	14	306*306
BPT15-33	380	380	341	224	306	14	306*306
BPT15-40	380	380	341	224	306	14	306*306
BPT15-60	380	380	341	224	306	14	306*306

 **ZhongDian** **Guangdong Zhongdian Jiajin Environmental Technology Co., Ltd.**



0085246403891



sales001@zd-fan.com



zd-fan.com

Xizi Industrial Zone, Lishui Town, Nanhai District, Foshan City, Guangdong Province, China