

Full Metal Case Ceiling Duct Ventilation Tubular Exhaust Fan

Our Product Introduction

for more products please visit us on zd-fan.com

Basic Information

- Place of Origin: China Foshan
- Brand Name: Available for ODM
- Certification: CE
- Model Number: BPT10-12
- Minimum Order Quantity: 1
- Price: Contact Us
- Packaging Details: Carton packaging 1 units per carton
- Delivery Time: 3-8 work days
- Payment Terms: T/T
- Supply Ability: 5000



Product Specification

- Type: Axial Flow Fan
- Applicable Industries: Hotels, Building Material Shops, Home Use, Retail, Construction Works
- Mounting: Ceiling Mounting
- Motor: Capacitor Copper Wire Motor
- Noise: MAX 45 DB
- Voltage (V): 220V
- Air Flow: 120-500 M³/h
- Highlight: **Tubular Exhaust Fan for Ventilation, Ceiling Duct Tubular Exhaust Fan, Full Metal Case Tubular Exhaust Fan**



More Images

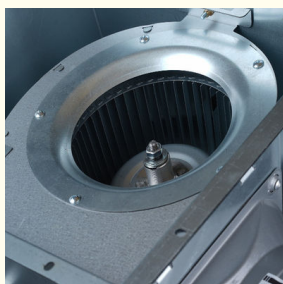

Product Description

Product Overview

Ceiling Duct Ventilation Fan is a ceiling-mounted fan designed for modern home and commercial Spaces. Its unique passageway structure and excellent air circulation effect provide excellent silence performance, bringing unparalleled comfort to your living and working environment.

Advantage

High efficiency and energy saving:

Advanced DC motor technology for lower power consumption and smoother operation.

Supports multi-speed wind speed adjustment to meet the ventilation requirements in different scenarios.

Mute design:

Specially optimized fan design and motor structure ensure almost no noise during operation.

Quality materials:

High quality metal, durable, rust and corrosion prevention.

Built-in overheat protection to ensure safe use.

Easy to install:

Complete with detailed installation instructions and required accessories for easy DIY or professional installation.

Safety guarantee:

Built-in overheat protection to ensure safe use.

General assembly Drawing

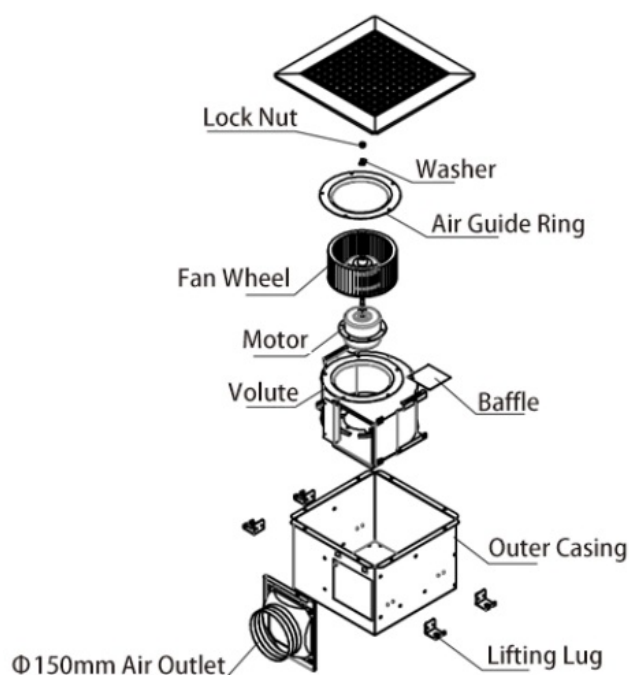

Product Installation Method

1. Begin by building a sturdy rectangular frame, ensuring it is solidly anchored to the ceiling above.

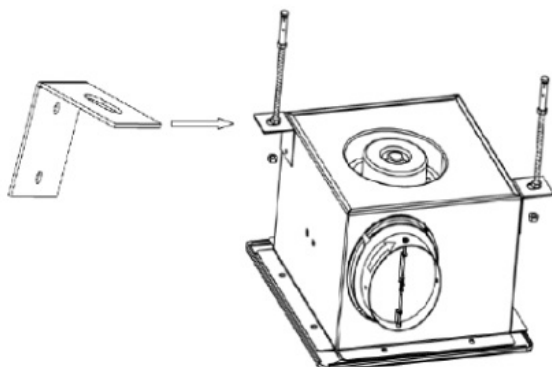

2. Firmly affix the storage unit (or enclosure) to the pre-installed frame.

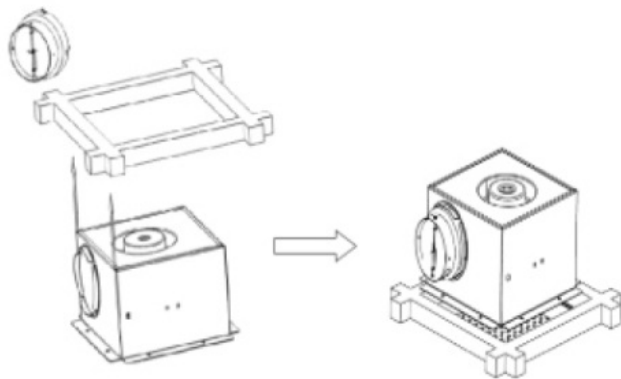

3. Carefully line up the ventilation duct connector with the arrow direction indicated and securely attach it using a twist-lock mechanism to the designated air outlet port on the cabinet, ensuring proper airflow connection.

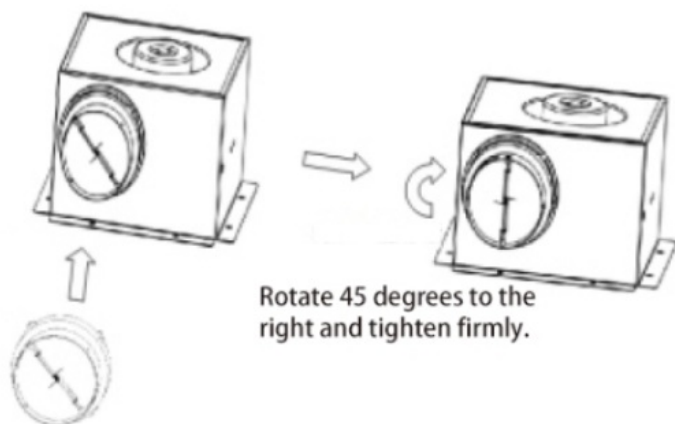

Rotate 45 degrees to the right and tighten firmly.

Fasten the air duct interface to the air inlet and outlet.

Product Performance Curve

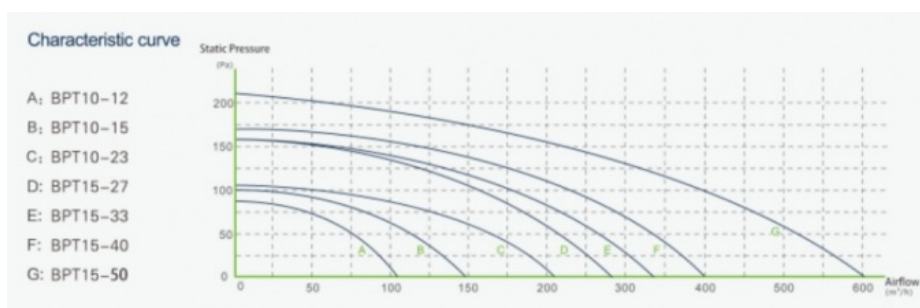

Product Performance Specifications

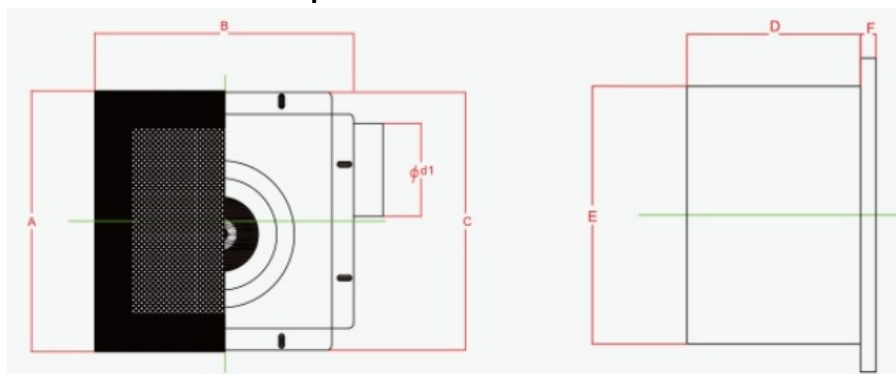

Model Num	A	B	C	D	E	F	Cutout Dimensions
BPT10-12	280	280	277	155	230	14	230*240
BPT10-15	280	280	277	155	230	14	230*240
BPT10-21	280	280	277	155	230	14	230*240

BPT15-27	380	380	341	224	306	14	306*306
BPT15-33	380	380	341	224	306	14	306*306
BPT15-40	380	380	341	224	306	14	306*306
BPT15-60	380	380	341	224	306	14	306*306

 **ZhongDian** **Guangdong Zhongdian Jiajin Environmental Technology Co., Ltd.**



0085246403891



sales001@zd-fan.com



zd-fan.com

Xizi Industrial Zone, Lishui Town, Nanhai District, Foshan City, Guangdong Province, China