

Quiet Air Extractor Powerful Ventilation Bathroom Exhaust Fan

Our Product Introduction

for more products please visit us on zd-fan.com

Basic Information

- Place of Origin: China Foshan
- Brand Name: Available for ODM
- Certification: CE
- Model Number: BPT10-12
- Minimum Order Quantity: 1
- Price: Contact Us
- Packaging Details: Carton packaging 1 units per carton
- Delivery Time: 3-8 work days
- Payment Terms: T/T
- Supply Ability: 5000



Product Specification

- Type: Ceiling Exhaust Duct Blower Fan
- Applicable Industries: Exhaust Ventilation
- Mounting: Ceiling Mounted
- Motor: Capacitor Copper Wire Motor
- Noise: MAX 45 DB
- Voltage (V): 220V
- Air Flow: 120-500 M³/h
- MOQ: 30 Set
- Feature: Low Noise, High Air Pressure, High Quality Motor
- Highlight: **Powerful Bathroom Exhaust Fan, Ventilation Bathroom Exhaust Fan, Quiet Bathroom Exhaust Fan**



More Images

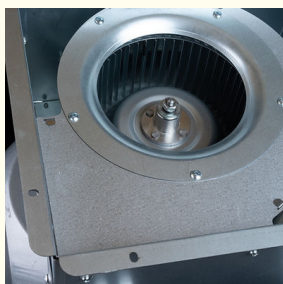

Product Description

Product Overview

Elevate your living spaces with our expertly designed extraction fans, meticulously crafted to whisk away humidity from bathrooms, laundries, washrooms, and toilets. Catering to diverse spatial needs, our collection spans from compact solutions perfect for intimate toilet enclosures to robust systems ideal for expansive indoor aquatic centers. With both exhaust and in-line ventilation options at your disposal, these fans excel at their primary mission: efficiently capturing moisture and channeling it outdoors via discreet ductwork, ensuring a fresher, healthier environment within your home.

Advantage

- **QUIET OPERATION:** Designed with silent-clever technology this bathroom exhaust fan operates, ensuring a super-quiet ventilation system while still moving large volumes of air.
- **EFFICIENT PERFORMANCE:** The exhaust fan efficiently ventilates perfect bathroom fan for maintaining a peaceful environment while efficiently removing moisture and odors.
- **Full Metal HOUSING:** Built with high-quality metal and a heavy-duty motor, this bathroom ceiling fan is engineered for continuous operation. Lifetime lubrication and thermal protection of the bathroom vent ensure long-lasting performance.

General assembly Drawing

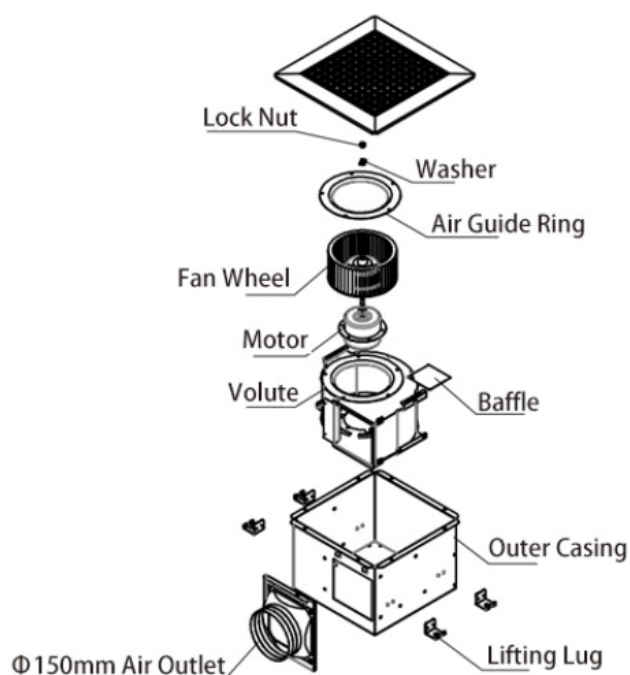

Product Installation Method

1. Begin by building a sturdy rectangular frame, ensuring it is solidly anchored to the ceiling above.

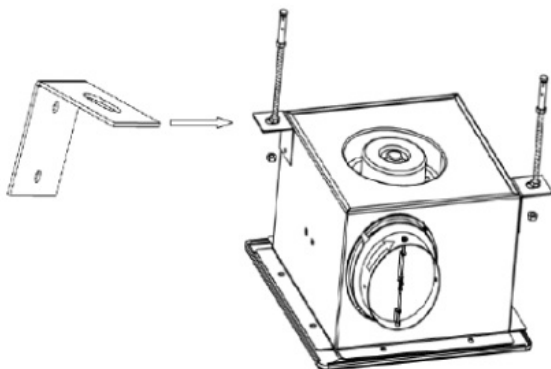

2. Firmly affix the storage unit (or enclosure) to the pre-installed frame.

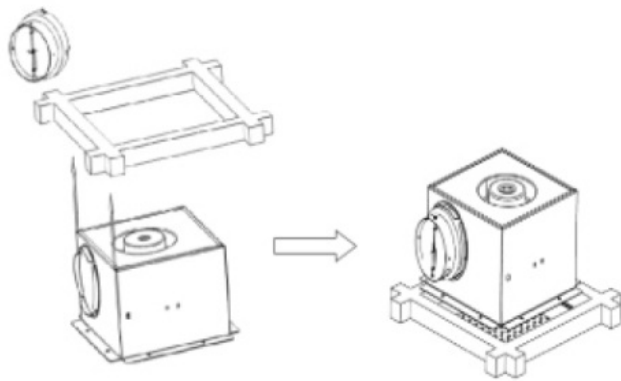

3. Carefully line up the ventilation duct connector with the arrow direction indicated and securely attach it using a twist-lock mechanism to the designated air outlet port on the cabinet, ensuring proper airflow connection.

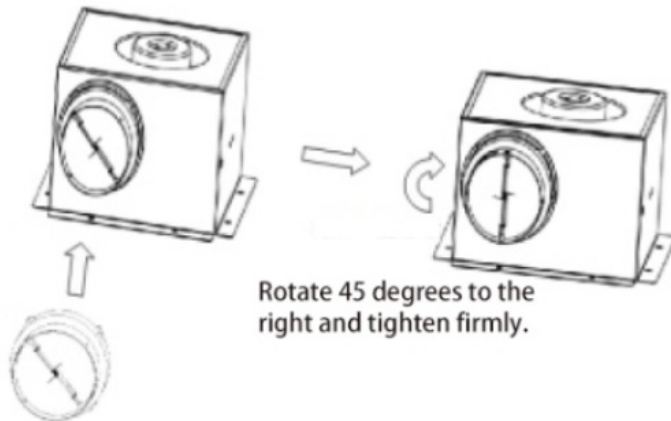

Rotate 45 degrees to the right and tighten firmly.

Fasten the air duct interface to the air inlet and outlet.

Product Performance Curve

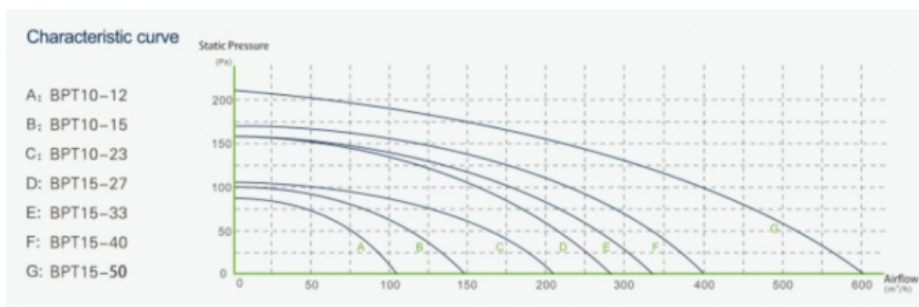

Product Performance Specifications

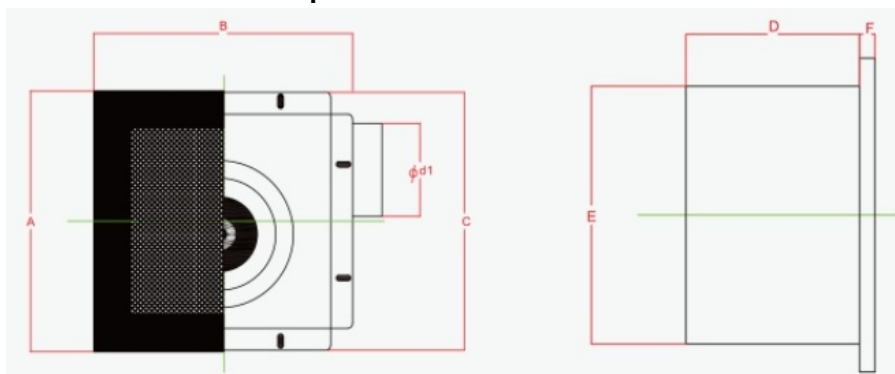

Model Num	A	B	C	D	E	F	Cutout Dimensions
BPT10-12	280	280	277	155	230	14	230*240
BPT10-15	280	280	277	155	230	14	230*240
BPT10-21	280	280	277	155	230	14	230*240

BPT15-27	380	380	341	224	306	14	306*306
BPT15-33	380	380	341	224	306	14	306*306
BPT15-40	380	380	341	224	306	14	306*306
BPT15-60	380	380	341	224	306	14	306*306

APPLICATIONS

- Clean Room
- Lab
- Packing Room
- Production Area

 **ZhongDian** **Guangdong Zhongdian Jiajin Environmental Technology Co., Ltd.**



0085246403891



sales001@zd-fan.com



zd-fan.com

Xizi Industrial Zone, Lishui Town, Nanhai District, Foshan City, Guangdong Province, China