

## Fresh Air Extraction Fans Single Room Ventilation Systems

### Our Product Introduction

for more products please visit us on [zd-fan.com](http://zd-fan.com)

#### Basic Information

- Place of Origin: China Foshan
- Brand Name: Available for ODM
- Certification: CE
- Model Number: BPT10-12
- Minimum Order Quantity: 1
- Price: Contact Us
- Packaging Details: Carton packaging 1 units per carton
- Delivery Time: 3-8 work days
- Payment Terms: T/T
- Supply Ability: 5000



#### Product Specification

- Function: Ceiling Air Flow Ventilator System
- Mounting: Ceiling
- Voltage: 220V
- Power: 24-100W
- Air Volume: 120-600 M³/h
- Core Components: Motor, Engine
- Noise: 32-58 DB
- Static Pressure(Pa): 80-220 Pa
- Motor: 100% Copper Coil
- Duct Size: 100 Mm / 150 Mm
- Applications: Hotel / School / Residence / Office / Bathroom
- Highlight: **Fresh Air Extraction Fans, Single Room Ventilation Fans**



#### More Images

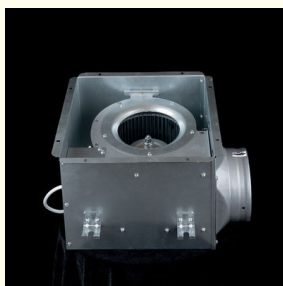

## Product Description

### Product Overview

Ceiling cassette exhaust fans have compact chassis made from high strength plastic and its decorative high-gloss front panel is very durable and warp-resistant. The fans are equipped with a very efficient motor and a unique spiral ducting design for easy air inflow resulting to minimal air flow noise. The fans are also provided with a back flow damper to prevent the backflow of outside air into the room.

### FEATURES & ADVANTAGES

Premium Ventilation Fan, Enhanced Durability and Performance

- **Painted Metal Grille:** Ensures maximum durability and longevity.
- **Corrosion-Resistant Housing:** Painted metal housing provides exceptional resistance to corrosion.
- **High-Quality Motor:** Engineered for the quietest and most powerful performance.
- **Low dB Levels:** Offers environmental comfort with minimal noise.
- **High Static Pressure:** Perfect for long duct runs, ensuring efficient airflow.

### General assembly Drawing

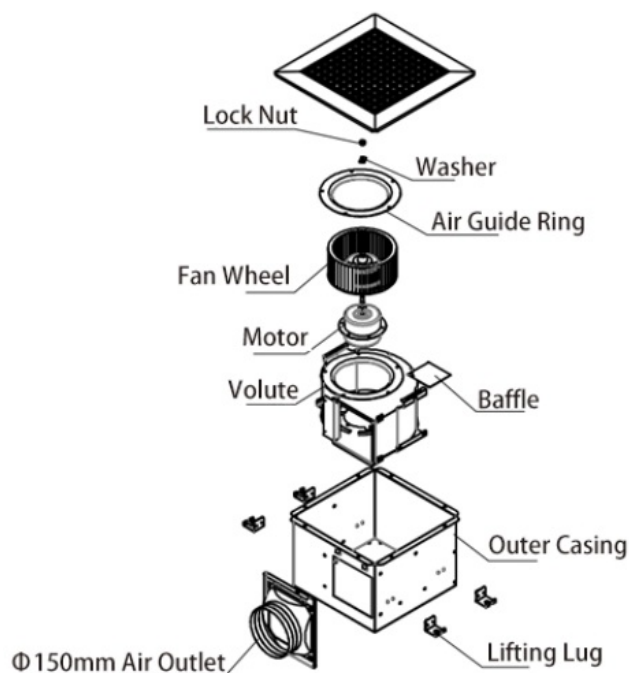

### Product Installation Method

1. Begin by building a sturdy rectangular frame, ensuring it is solidly anchored to the ceiling above.

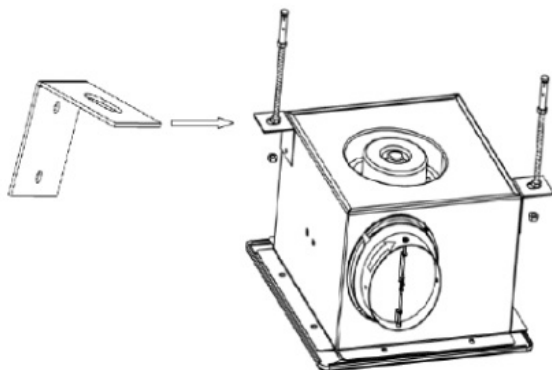

2. Firmly affix the storage unit (or enclosure) to the pre-installed frame.

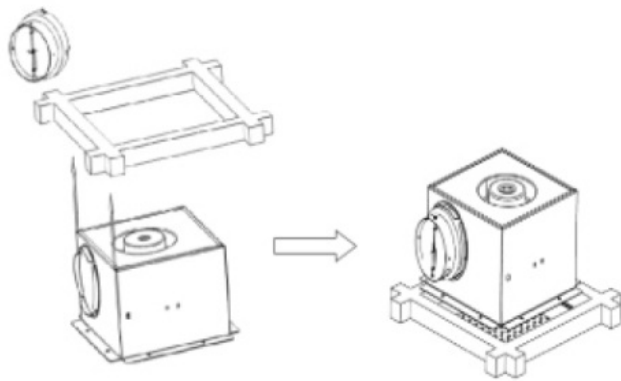

3. Carefully line up the ventilation duct connector with the arrow direction indicated and securely attach it using a twist-lock mechanism to the designated air outlet port on the cabinet, ensuring proper airflow connection.

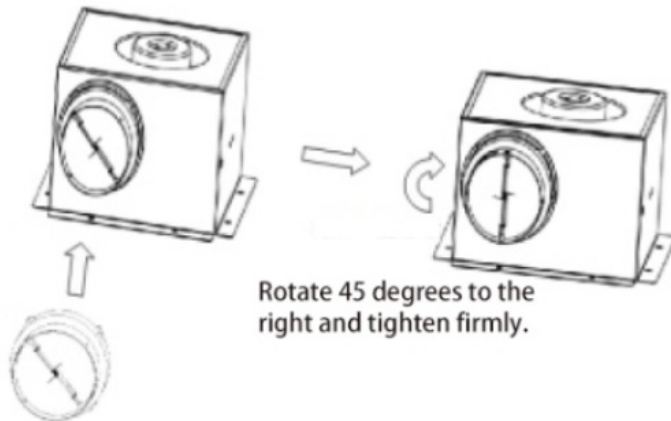

Rotate 45 degrees to the right and tighten firmly.

Fasten the air duct interface to the air inlet and outlet.

## Product Performance Curve

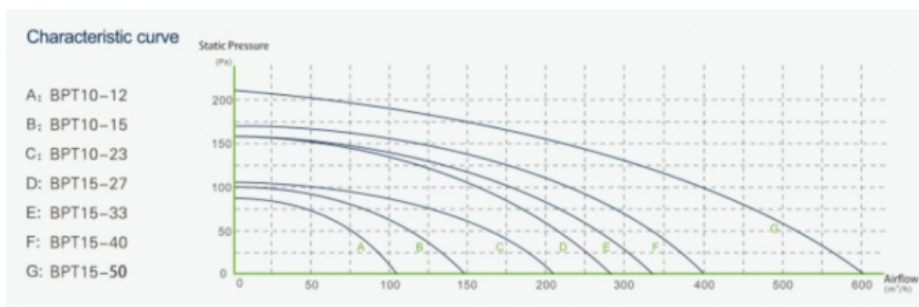

## Product Performance Specifications

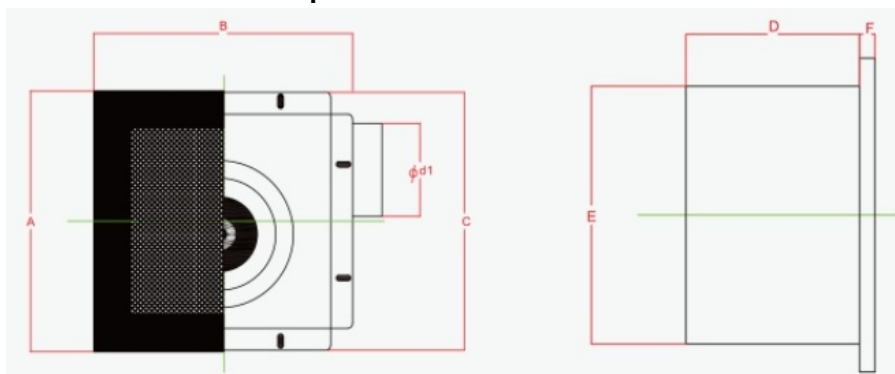

Model Num	A	B	C	D	E	F	Cutout Dimensions
BPT10-12	280	280	277	155	230	14	230*240
BPT10-15	280	280	277	155	230	14	230*240
BPT10-21	280	280	277	155	230	14	230*240

BPT15-27	380	380	341	224	306	14	306*306
BPT15-33	380	380	341	224	306	14	306*306
BPT15-40	380	380	341	224	306	14	306*306
BPT15-60	380	380	341	224	306	14	306*306

 **ZhongDian** **Guangdong Zhongdian Jiajin Environmental Technology Co., Ltd.**



0085246403891



sales001@zd-fan.com



zd-fan.com

Xizi Industrial Zone, Lishui Town, Nanhai District, Foshan City, Guangdong Province, China