

Bathroom Ceiling Mounted Duct Indoor Fresh Air Exhaust Ventilator System

Our Product Introduction

for more products please visit us on zd-fan.com

Basic Information

- Place of Origin: China Foshan
- Brand Name: Available for ODM
- Certification: CE
- Model Number: BPT10-12
- Minimum Order Quantity: 1
- Price: Contact Us
- Packaging Details: Carton packaging 1 units per carton
- Delivery Time: 3-8 work days
- Payment Terms: T/T
- Supply Ability: 5000



Product Specification

- Function: Air Flow Exhaust Ventilator
- Mounting: Ceiling Mounting
- Voltage: 220V 50 Hz
- Power: 24-100W
- Air Volume: 120 - 500 M³/h
- Core Components: Motor & Engine
- Noise: 32-46dB
- Static Pressure(Pa): 80-175 Pa
- Motor: Copper Coil
- Duct Size: 100 Mm / 150 Mm
- Applications: Hotel / School / Residence / Office / Bathroom
- Color: Metal Grey
- Highlight: Indoor Fresh Air Exhaust Ventilator,
Bathroom Ceiling Mounted Exhaust Ventilator,
Indoor Ceiling Mounted Exhaust Ventilator



More Images

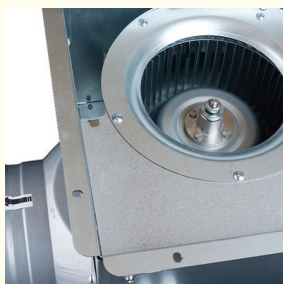

Product Description

Product Overview

Ceiling fans enhance indoor air quality by controlling humidity, removing odors, and minimizing dust. They are adaptable for malls, hotels, restaurants, homes, and offices.

Advantage

The metal casing complies with fire resistance standards, ensuring safety and durability.

A capacitor-run induction motor is utilized, delivering low power consumption, high performance, longevity, and dependability.

A detachable cassette-type discharge opening is designed for effortless ducting, installation, and maintenance.

A variety of visually appealing design louvers are available for selection to match any aesthetic. Mounting feet are included for convenient suspension and ceiling installation, making setup straightforward. The uniform height level of inlet and outlet ensures an optimal position suitable for the ducting system.

A well-balanced, high-grade aluminum high-pressure forward curved centrifugal fan guarantees quiet and stable operation, enhancing overall efficiency.

General assembly Drawing

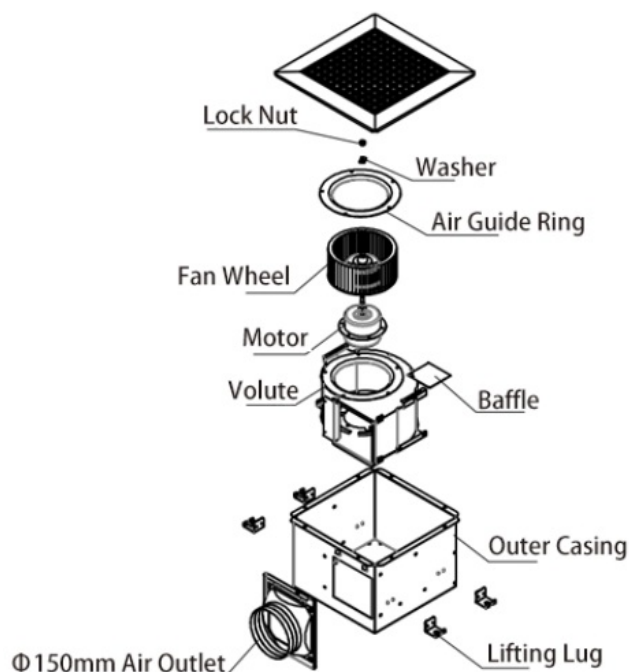

Product Installation Method

1. Begin by building a robust rectangular frame, ensuring it is firmly attached to the ceiling above.

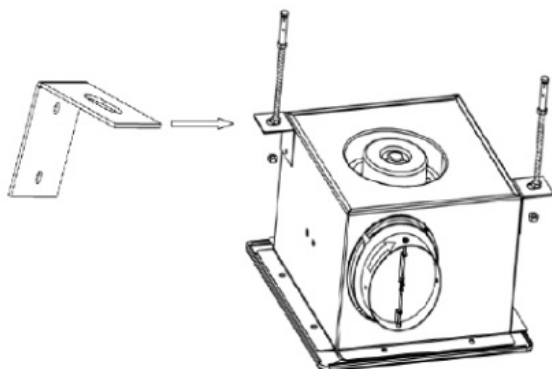

2. Firmly attach the storage unit (or enclosure) to the pre-installed frame.

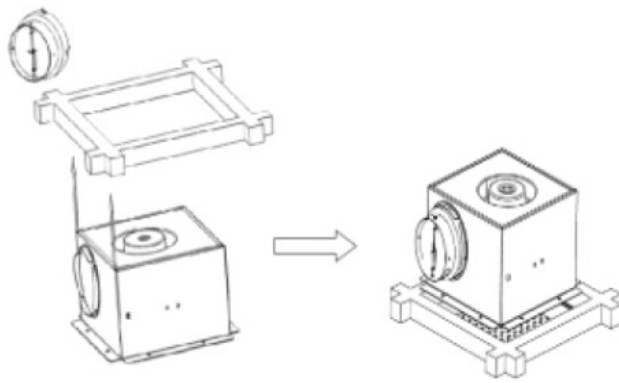

3. Carefully align the ventilation duct connector with the arrow direction indicated and securely attach it using a twist-lock mechanism to the specified air outlet port on the cabinet, ensuring correct airflow connection.

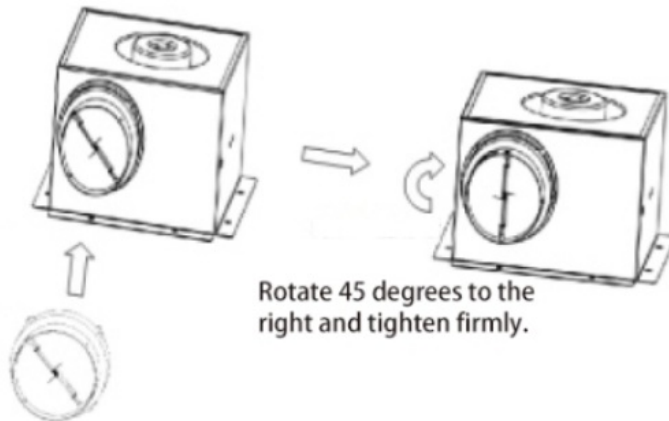

Rotate 45 degrees to the right and tighten firmly.

Fasten the air duct interface to the air inlet and outlet.

Product Performance Curve

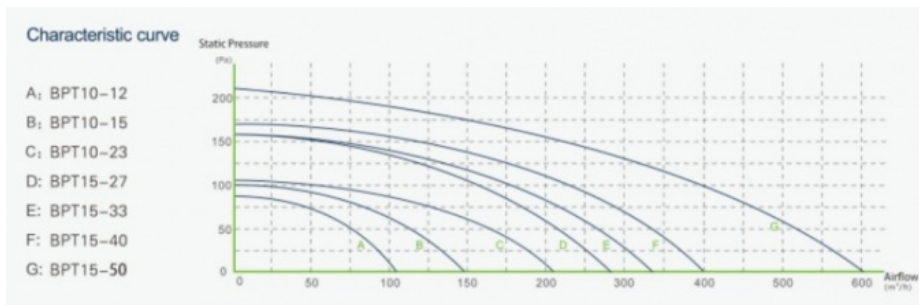

Product Performance Specifications

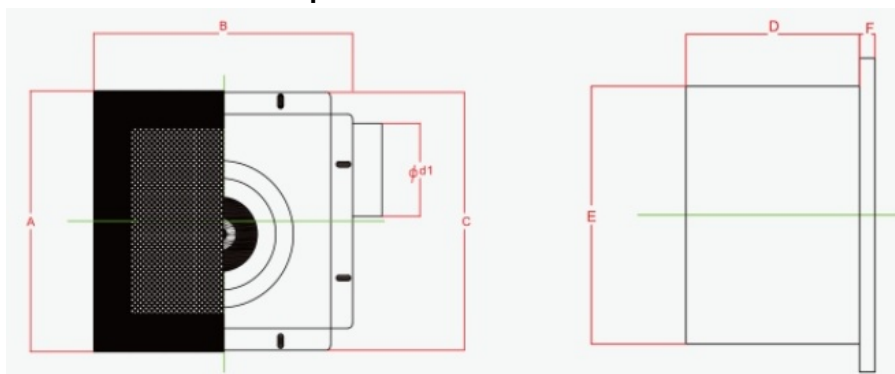

Model Num	A	B	C	D	E	F	Cutout Dimensions
BPT10-12	280	280	277	155	230	14	230*240
BPT10-15	280	280	277	155	230	14	230*240
BPT10-21	280	280	277	155	230	14	230*240

BPT15-27	380	380	341	224	306	14	306*306
BPT15-33	380	380	341	224	306	14	306*306
BPT15-40	380	380	341	224	306	14	306*306
BPT15-60	380	380	341	224	306	14	306*306

 **ZhongDian** **Guangdong Zhongdian Jiajin Environmental Technology Co., Ltd.**



0085246403891



sales001@zd-fan.com



zd-fan.com

Xizi Industrial Zone, Lishui Town, Nanhai District, Foshan City, Guangdong Province, China