

Full Metal Housing Ceiling Pipe Indoor Soundless Ventilation Fan

Our Product Introduction

for more products please visit us on zd-fan.com

Basic Information

- Place of Origin: China Foshan
- Brand Name: Available for ODM
- Certification: CE
- Model Number: BPT10-12
- Minimum Order Quantity: 1
- Price: Contact Us
- Packaging Details: Carton packaging 1 units per carton
- Delivery Time: 3-8 work days
- Payment Terms: T/T
- Supply Ability: 5000



Product Specification

- Function: Air Flow Circulation
- Mounting: Ceiling
- Voltage: 220V
- Power: 24-100W
- Air Volume: 120-600 M³/h
- Core Components: Motor, Engine
- Noise: 32-58 DB
- Static Pressure(Pa): 80-220 Pa
- Motor: 100% Copper Coil
- Duct Size: 100 Mm / 150 Mm
- Applications: Hotel / School / Residence / Office / Bathroom
- Highlight: Full Metal Housing Ventilation Fan, Ceiling Pipe Ventilation Fan, Indoor Soundless Ventilation Fan



More Images

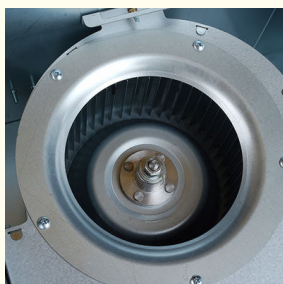

Product Description

Product Overview

Ceiling fans improve indoor air quality by regulating humidity levels, eliminating odors, and reducing dust accumulation. They are suitable for a variety of settings including malls, hotels, restaurants, residential homes, and office spaces.

Advantage

Metal casing serves the requirement of fire retardant.

Capacitor run induction motor is adopted with lower input power, high performance, long durability and reliability

Detachable cassette type discharge opening is designed for convenient ducting, installation and maintenance

Various aesthetically pleasing design louvers for selection.

Mounting feet are included for easy suspending and ceiling installation.

Same height level of inlet and outlet allows an intermediate position for ducting system.

Well balanced, high graded aluminum high pressure forward curved centrifugal fan for quiet and stable operation.

General assembly Drawing

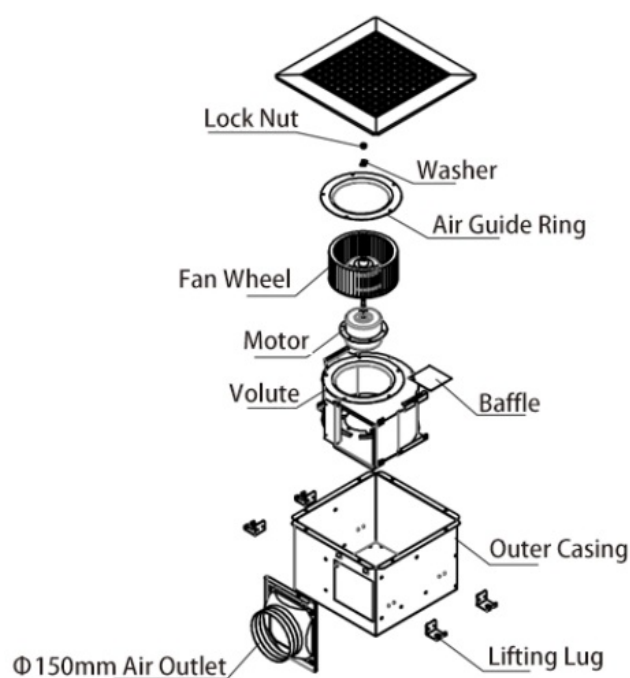

Product Installation Method

1. Start by constructing a sturdy rectangular framework, making sure it is securely fastened to the ceiling above.

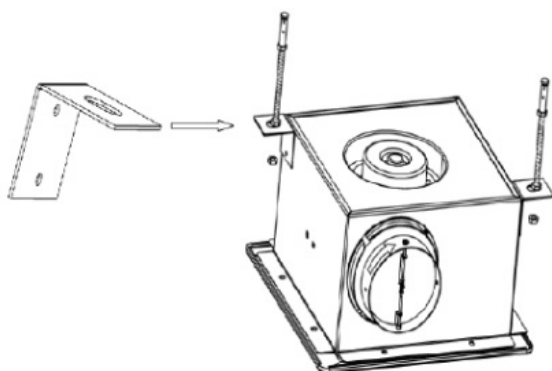

2. Firmly secure the storage unit (or enclosure) to the pre-installed frame.

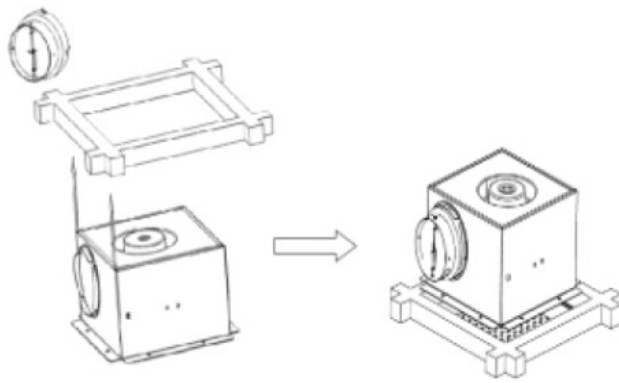

3. Carefully align the ventilation duct connector with the arrow direction indicated and firmly attach it using a twist-lock mechanism to the designated air outlet port on the cabinet, ensuring proper airflow connection.

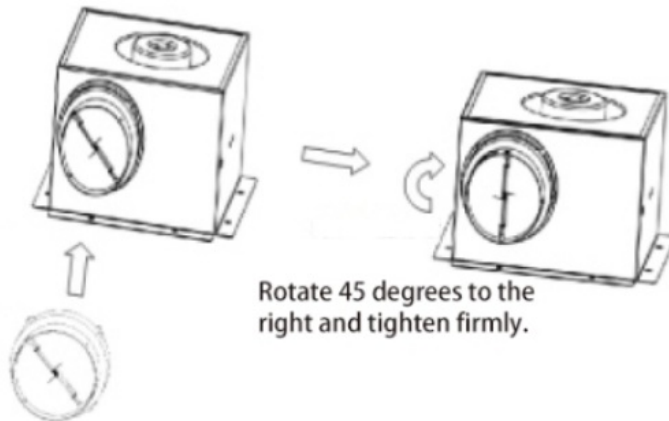

Rotate 45 degrees to the right and tighten firmly.

Fasten the air duct interface to the air inlet and outlet.

Product Performance Curve

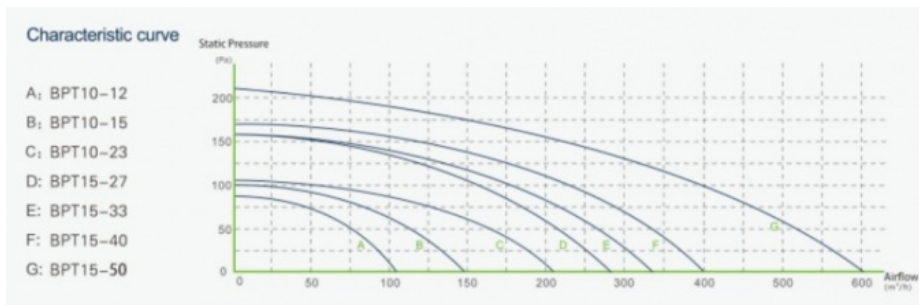

Product Performance Specifications

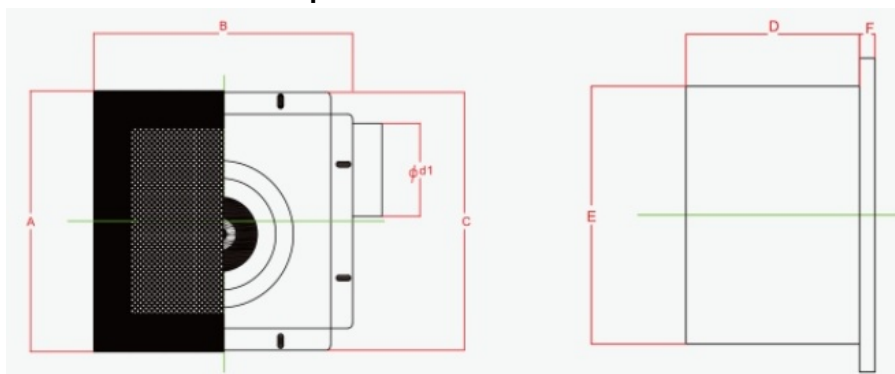

Model Num	A	B	C	D	E	F	Cutout Dimensions
BPT10-12	280	280	277	155	230	14	230*240
BPT10-15	280	280	277	155	230	14	230*240
BPT10-21	280	280	277	155	230	14	230*240

BPT15-27	380	380	341	224	306	14	306*306
BPT15-33	380	380	341	224	306	14	306*306
BPT15-40	380	380	341	224	306	14	306*306
BPT15-60	380	380	341	224	306	14	306*306

 **ZhongDian** **Guangdong Zhongdian Jiajin Environmental Technology Co., Ltd.**



0085246403891



sales001@zd-fan.com



zd-fan.com

Xizi Industrial Zone, Lishui Town, Nanhai District, Foshan City, Guangdong Province, China