

## Full Metal Housing Indoor Smoking Fresh Air Exchanger Ventilation System

Our Product Introduction

for more products please visit us on [zd-fan.com](http://zd-fan.com)

### Basic Information

- Place of Origin: China Foshan
- Brand Name: Available for ODM
- Certification: CE
- Model Number: BPT10-12
- Minimum Order Quantity: 1
- Price: Contact Us
- Packaging Details: Carton packaging 1 units per carton
- Delivery Time: 3-8 work days
- Payment Terms: T/T
- Supply Ability: 5000



### Product Specification

- Function: Air Flow Circulation
- Mounting: Ceiling
- Voltage: 220V
- Power: 24-100W
- Air Volume: 120-600 M<sup>3</sup>/h
- Core Components: Motor, Engine
- Noise: 32-58 DB
- Static Pressure(Pa): 80-220 Pa
- Motor: 100% Copper Coil
- Duct Size: 100 Mm / 150 Mm
- Applications: Hotel / School / Residence / Office / Bathroom
- Highlight: Full Metal Housing Fresh Air Exchanger, Ventilation System Fresh Air Exchanger, Indoor Smoking Fresh Air Exchanger



### More Images

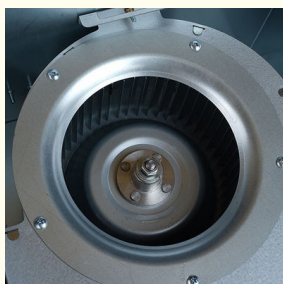

## Product Description

### Product Overview

FM ceiling fans enhance indoor air quality by controlling humidity, removing odors, and minimizing dust. They are adaptable for malls, hotels, restaurants, homes, and offices.

### Advantage

**Reliability:** Our motor fans are designed to exceed the lifespan of popular AC motor models by up to 70%, saving time and money on replacements.

**Efficiency:** Our motor fans rank among the most efficient ventilation fans available, with all Delta ventilation fans engineered to run continuously for at least 70,000 hours.

**Less Noise:** Our motor fans are expertly crafted for minimal sound output.

**Less Power consumption:** Our motor fans use up to 74% less power than standard AC motor exhaust fans.

### General assembly Drawing

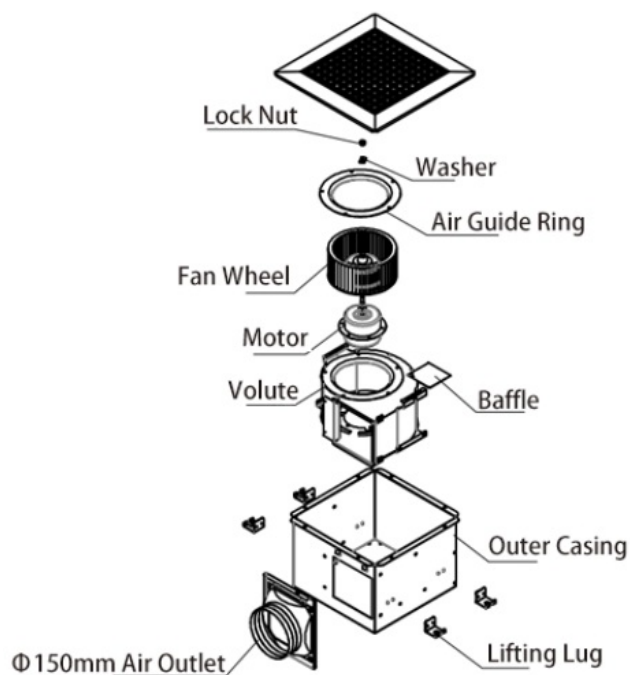

### Product Installation Method

1. Begin by building a strong rectangular frame, ensuring it is firmly attached to the ceiling above.

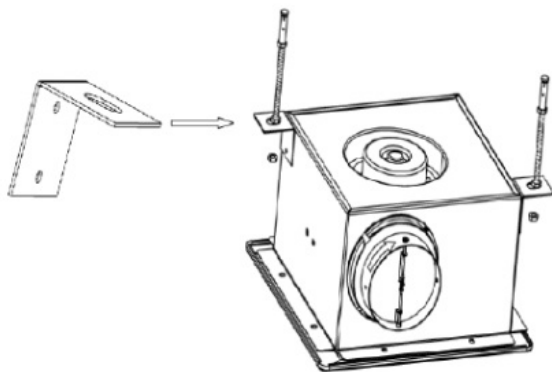

2. Firmly attach the storage unit (or enclosure) to the pre-installed frame.

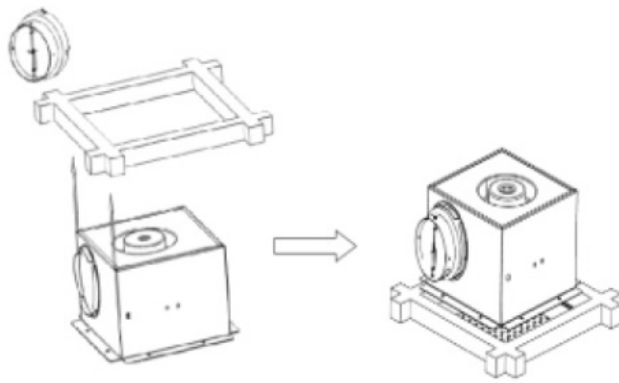

3. Carefully align the ventilation duct connector with the arrow direction indicated and securely attach it using a twist-lock mechanism to the specified air outlet port on the cabinet, ensuring correct airflow connection.

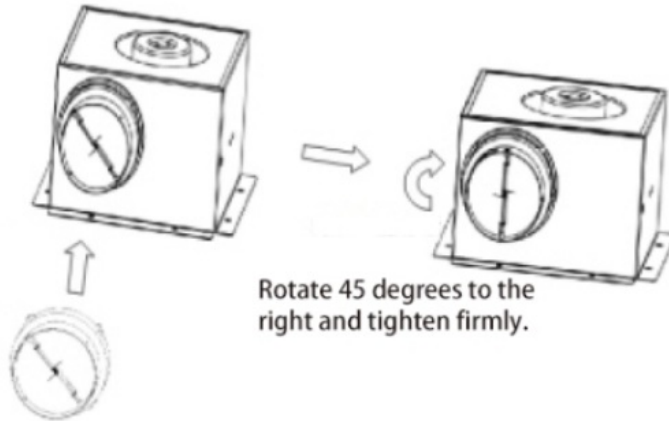

Rotate 45 degrees to the right and tighten firmly.

Fasten the air duct interface to the air inlet and outlet.

## Product Performance Curve

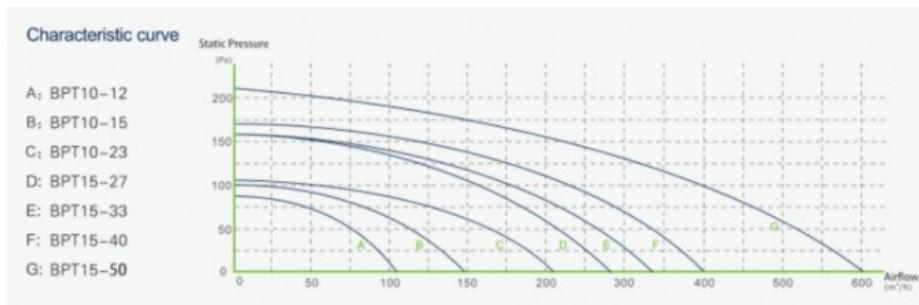

## Product Performance Specifications

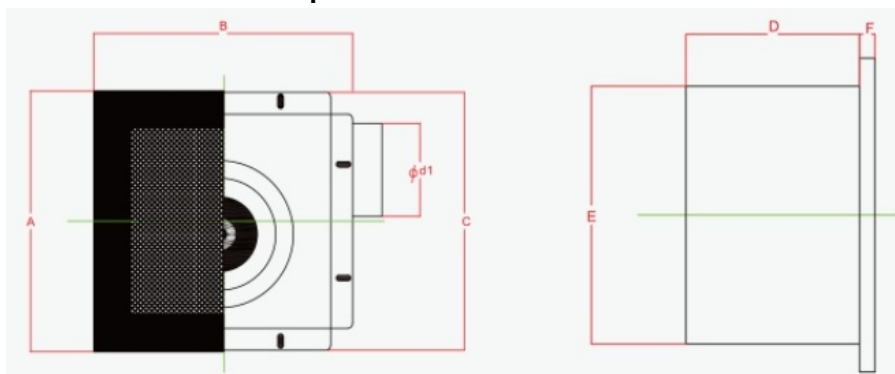

Model Num	A	B	C	D	E	F	Cutout Dimensions
BPT10-12	280	280	277	155	230	14	230*240
BPT10-15	280	280	277	155	230	14	230*240
BPT10-21	280	280	277	155	230	14	230*240

BPT15-27	380	380	341	224	306	14	306*306
BPT15-33	380	380	341	224	306	14	306*306
BPT15-40	380	380	341	224	306	14	306*306
BPT15-60	380	380	341	224	306	14	306*306

 **ZhongDian** **Guangdong Zhongdian Jiajin Environmental Technology Co., Ltd.**



0085246403891



sales001@zd-fan.com



zd-fan.com

Xizi Industrial Zone, Lishui Town, Nanhai District, Foshan City, Guangdong Province, China