

## Full Metal Shell High CFM Ceiling Mount Air Flow Ventilator System

Our Product Introduction

for more products please visit us on [zd-fan.com](http://zd-fan.com)

### Basic Information

- Place of Origin: China Foshan
- Brand Name: Available for ODM
- Certification: CE
- Model Number: BPT10-12
- Minimum Order Quantity: 1
- Price: Contact Us
- Packaging Details: Carton packaging 1 units per carton
- Delivery Time: 3-8 work days
- Payment Terms: T/T
- Supply Ability: 5000



### Product Specification

- Function: Ceiling Air Flow Ventilator System
- Mounting: Ceiling
- Voltage: 220V
- Power: 24-100W
- Air Volume: 120-600 M³/h
- Core Components: Motor, Engine
- Noise: 32-58 DB
- Static Pressure(Pa): 80-220 Pa
- Motor: 100% Copper Coil
- Duct Size: 100 Mm / 150 Mm
- Applications: Hotel / School / Residence / Office / Bathroom
- Highlight: **Ceiling Mount Air Flow Ventilator System, High CFM Air Flow Ventilator System**

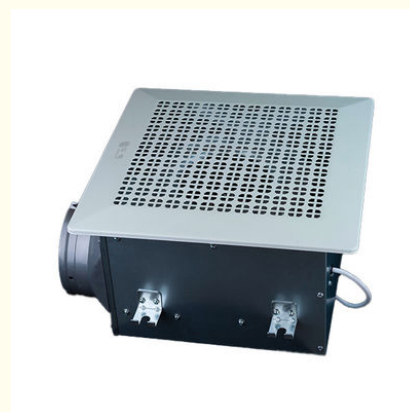

### More Images

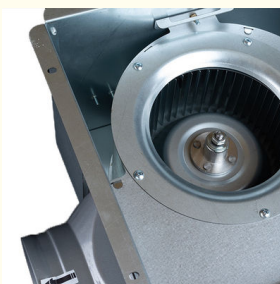

## Product Description

### Product Overview

Full metal ceiling fans improve indoor air quality by regulating humidity, eliminating odors, and reducing dust. These versatile fixtures are suitable for various environments including malls, hotels, restaurants, homes, and offices.

### Advantage

**Reliability:** Our motor fans are designed to last up to 70% longer than popular motor models, saving you both time and money on replacements.

**Efficiency:** Our motor fans are among the most efficient ventilation solutions available. All our Delta ventilation fans are precision-engineered to operate continuously for a minimum of 70,000 hours.

**Less Noise:** Our motor fans are meticulously engineered to produce minimal sound, ensuring a quieter environment.

**Less Power consumption:** Our motor fans consume up to 74% less power compared to popular motor exhaust fans, making them an energy-efficient choice.

### General assembly Drawing

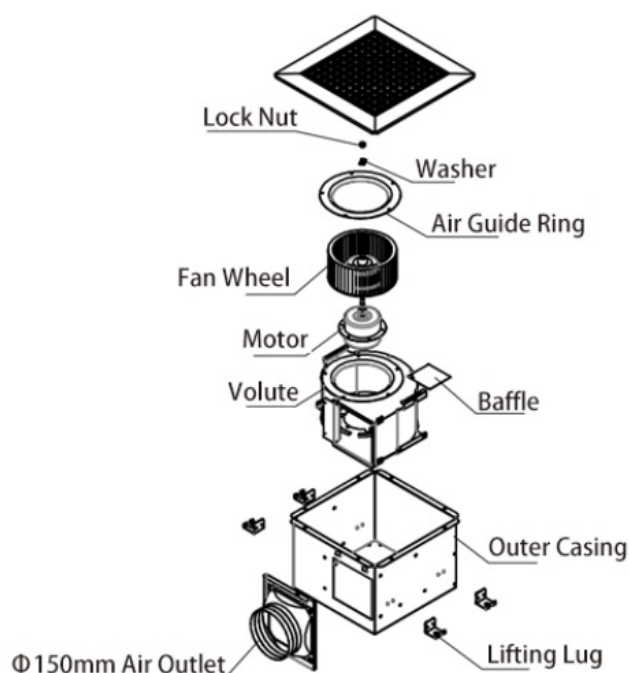

### Product Installation Method

1. Begin by building a sturdy rectangular frame, ensuring it is solidly anchored to the ceiling above.

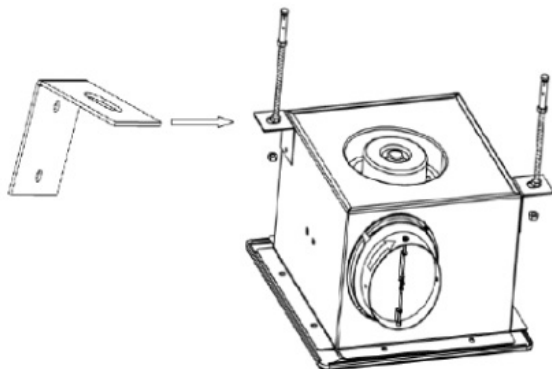

2. Firmly affix the storage unit (or enclosure) to the pre-installed frame.

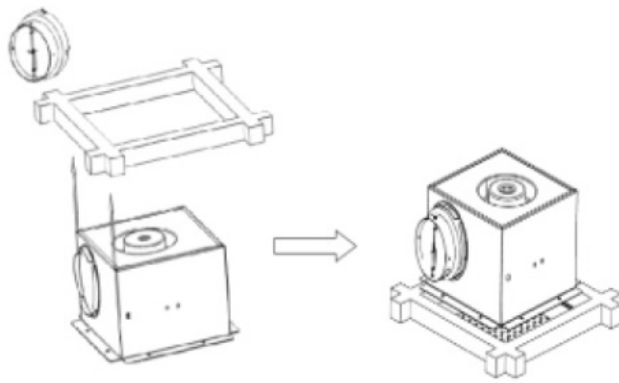

3. Carefully line up the ventilation duct connector with the arrow direction indicated and securely attach it using a twist-lock mechanism to the designated air outlet port on the cabinet, ensuring proper airflow connection.

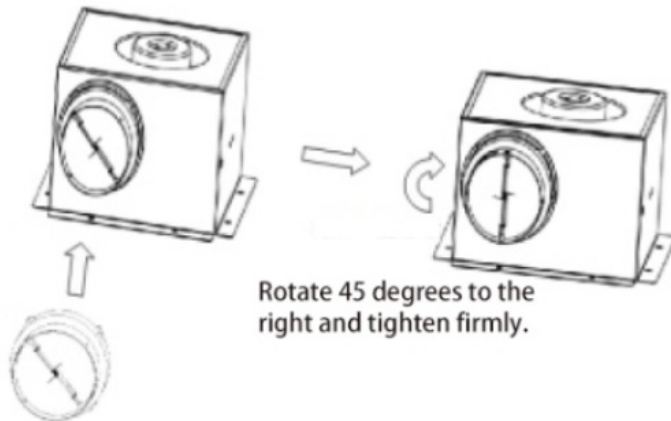

Rotate 45 degrees to the right and tighten firmly.

Fasten the air duct interface to the air inlet and outlet.

## Product Performance Curve

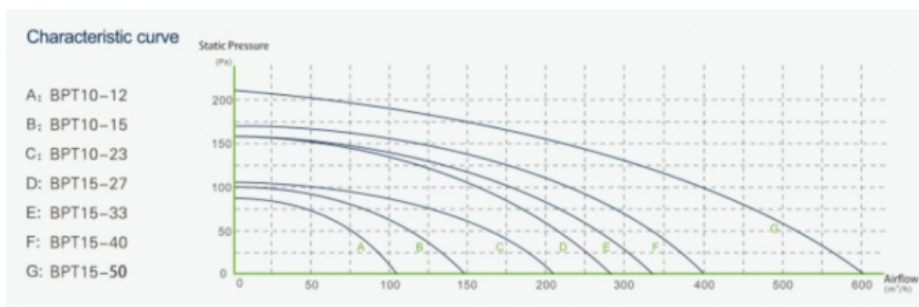

## Product Performance Specifications

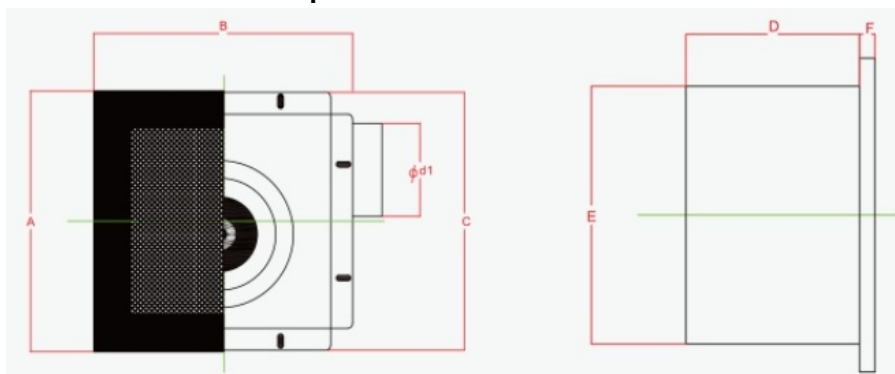

Model Num	A	B	C	D	E	F	Cutout Dimensions
BPT10-12	280	280	277	155	230	14	230*240
BPT10-15	280	280	277	155	230	14	230*240
BPT10-21	280	280	277	155	230	14	230*240

BPT15-27	380	380	341	224	306	14	306*306
BPT15-33	380	380	341	224	306	14	306*306
BPT15-40	380	380	341	224	306	14	306*306
BPT15-60	380	380	341	224	306	14	306*306

 **ZhongDian** **Guangdong Zhongdian Jiajin Environmental Technology Co., Ltd.**



0085246403891



sales001@zd-fan.com



zd-fan.com

Xizi Industrial Zone, Lishui Town, Nanhai District, Foshan City, Guangdong Province, China